

MS18

Features and Strengths

- 2/2way solenoid valve
- Compact size with high air flow rate
- Easily detachable Pin-type connection

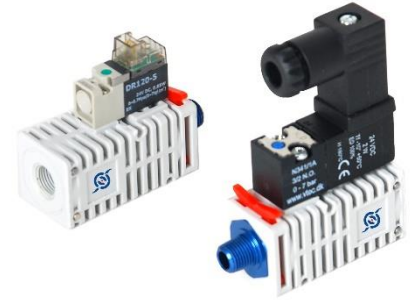
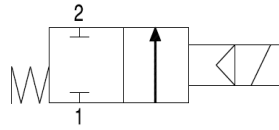

Specifications

Model	MS18
Connection	G1/8"
Normal flow	1,230 NI/m
Pressure range	2.5 ~ 7 bar
Temperature range	-18 ~ 65 °C
Material	NYLON, AL, SUM, Ni, SS, CuZn, NBR, PPS
Standard voltage	AC : 110V, 220V – 50/60Hz DC : 24V
Power consumption	0.85 ~ 1.3W
Weight	25g

Build an Ordering No.

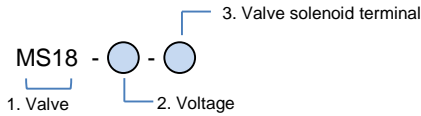

1. Valve	Description	Ordering No.
	2/2 way solenoid valve, PF1/8" female inlet	MS18
	2/2 way solenoid valve, PF1/8" male inlet	MS18M
2. Voltage	Description	Ordering No.
	AC110V	1
	AC220V	2
	DC24V	3
3. Valve terminal	Description	Ordering No.
	Solenoid Terminal, DIN, No LW	1
	Solenoid Terminal, DIN, Lamp, No LW	2
	Solenoid Terminal, Conn, Lamp & 0.3m LW: <i>Only available with DC24V</i>	3

Dimensions

DIN type

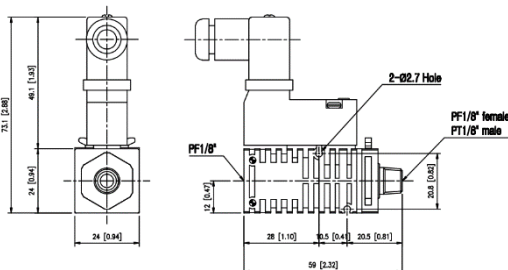

Connector type

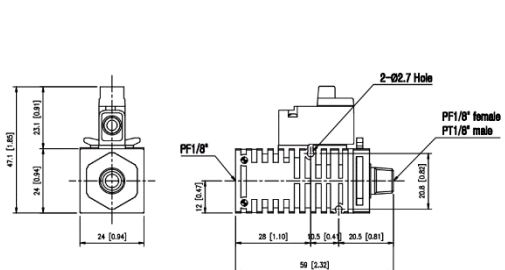

Unit : mm [inch]