

Torch heads DIX METZ 520/522/524/528

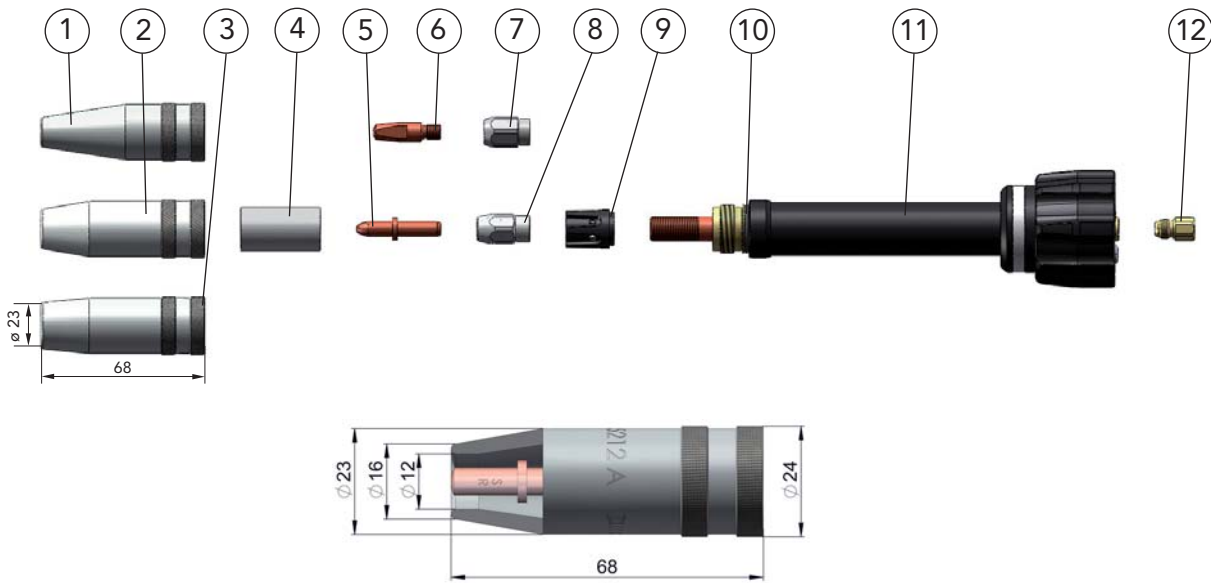

Description	Dimension	Part name	Part number
1 Gas nozzle	ID \varnothing 9 mm	DIX 1-3-5209 A	6390152090
2 Gas nozzle	ID \varnothing 12 mm	DIX 1-3-5212 A	6390152120
3 Gas nozzle	ID \varnothing 15 mm	DIX 1-3-5215 A	6390152150
4 Insulator For pos. 2 and 3		DIX 2-3-520	6390252000
5 Contact tip	\varnothing 6 x 35 mm	DIX 3-1-__ SR	6190354__
6 Contact tip	M6 x 28 mm	DIX 3-2-__	6290300__
Contact tip	M6 x 28 mm	DIX 3-2-__ CR-ZR	6290330__
7 Tip adapter		DIX GS 1-K	618150001
8 Clamp nut		DIX 4-1-MAS	6390452000
9 Gas diffusor		DIX 10-1-MAS	6391052000
10 O - ring	(10 pcs.)		639060002
11 Torch neck	0°	DIX 6-3-520 METZ	6390635200
Torch neck	22°	DIX 6-3-522 METZ	6390635220
Torch neck	45°	DIX 6-3-524 METZ	6390635240
Torch neck	30°	DIX 6-3-528 METZ	6390635280
12 Connecting piece		DIX MES 300/500	639061500041
Connecting piece, MEPTZ (without picture)		DIX MEPS 300/500	6390665000
Clamp sleeve (without picture)		DIX SH 270	629270270

__ Enter the required wire diameter, e.g.: 08 = 0.8 mm or 10 = 1.0 mm.

- Standard equipment for wire diameter 1.0 mm steel with gas nozzle diameter 12 mm, DIX 1-3-5212 A, (contact tip, DIX 3-1-1.0 S, flush, clamp sleeve DIX 4-1-MAS, Gas diffusor DIX 10-1 MAS). Use the hook spanner DIX SLAT 4 to fix the torch heads.

