

# HY 19079



**Filter media:** INORGANIC FIBERGLASS  
**Filter area:** 1.069 cm<sup>2</sup> 166 Sq. inch  
**Efficiency:** 10 μm (c) at β= 200 in accordance to ISO 16889  
 12 μm (c) at β= 1000 in accordance to ISO 16889  
**Dirt holding capacity in accordance to ISO 16889 at final Dp 5 bar:** 16,25 gr. ISO MTD  
**Collapse pressure in accordance to ISO 2941:** 210 Bar. 3045 Psi.

**By-pass valve:** NO **By-pass setting:** Bar. Psi.  
**Operating temperature:** min -25 °C max 120 °C  
**Flow:** EST-INT **Seal:** NBR  
**Fluid compatibility :** mineral oil (HH,HL,HM,HV)  
**Notes :**

Pressure drop charts in accordance to ISO 3968 (Class B) at clean element 30 cst viscosity 0,86 Kg/dm<sup>3</sup> density mineral oil.

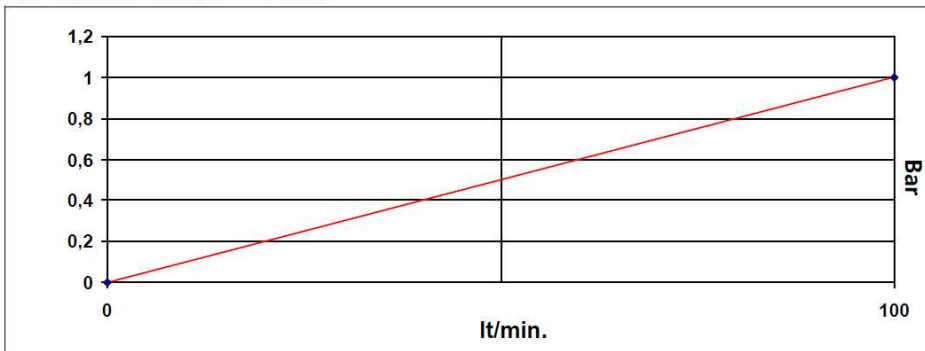

**Q:** 100 lt/min.  
**Dp:** 1 Bar.  
  
**Q:** 26,42 GPM  
**Dp:** 14,50 PSI

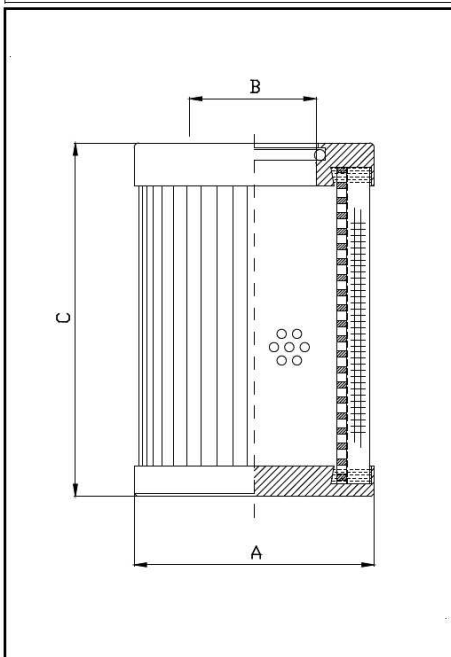

**mm**  
**A** 45  
**B** 25,4  
**C** 210  
**D**  
**E**  
**F**  
  
**inch**  
**A** 1,77  
**B** 1,00  
**C** 8,27  
**D**  
**E**  
**F**

Technical drawing not in scale

