

5 Series Aluminum Extrusions 20, 25, 40mm Square

1 Slot

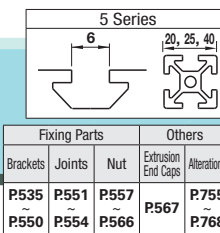

Features: Small and light aluminum extrusions suited for locations where small forces apply, such as for covers and safety fences.

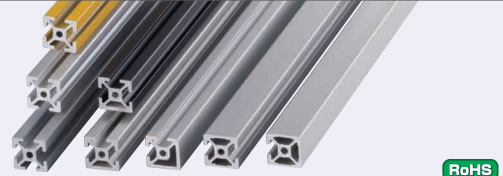

Type		Material	Surface Treatment
Configurable Length	Fixed Length		
NFS_5	KNFS_5	EN AW-6063-T5 Equiv.	Clear Anodize
NFSB5	KNFSB5		Black Anodize
HFS_5	KHFS_5		Clear Anodize
HFSB5	KHFSB5	EN AC-51400-T5 Equiv.	Black Anodize
CAF5	KCAF5		Clear Coating (Anodize + Clear Paint)
HFSY5	KHFSY5		Baked Paint (Yellow)

⚠ Cut surface and altered parts are not surface treated.
 ⚠ The color of HFSY5 is D22-80V (Japan Paint Manufacturers Association, Munsell Value Reference 2.5Y8/12).

NFS5-2020
NFSB5-2020 (Black Anodize)
HFS5-2020
HFSB5-2020 (Black Anodize)
CAF5-2020 (Clear Coating)
HFSY5-2020 (Baked Paint, Yellow)

NFSF5-2020
HFSF5-2020
HFSFB5-2020 (Black Anodize)

NFST5-2020
HFST5-2020
HFSTB5-2020 (Black Anodize)

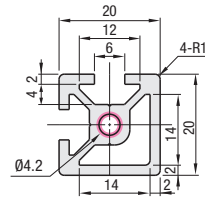
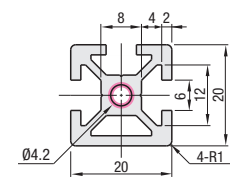
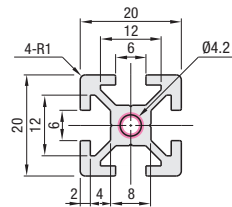

HFSH5-2020

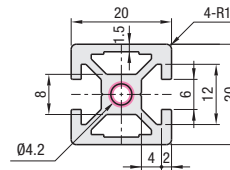

HFSC5-2020

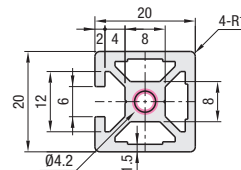

Configurable Length Extrusions

Part Number	L 0.5mm Increment	Mass kg/m	Sectional Area mm ²	Cross Sectional Moment of Inertia mm ⁴		Unit Price (Less than 300mm) 1 - 9 pc(s).	Volume Discount Rate Less Than 300mm		Unit Price/m (300mm or More)	Volume Discount Rate 300mm or More	
				ℓx	ℓy		10-49	50-160		10-49	50-160
NFS5	2020	0.5	183	0.742x10 ⁴	0.742x10 ⁴	1-9 pc(s)	10-49	50-160	1-9 pc(s)	10-49	50-160
NFSB5 (Black Anodize)											
HFS5											
HFSB5 (Black Anodize)											
CAF5 (Clear Coating)											
HFSY5 (Baked Paint, Yellow)											
NFSF5		0.53	195	0.834x10 ⁴	0.746x10 ⁴	1-9 pc(s)	10-49	50-160	1-9 pc(s)	10-49	50-160
HFSF5											
HFSFB5 (Black Anodize)											
NFST5											
HFST5											
HFSTB5 (Black Anodize)											
HFSH5	0.56	199	0.74x10 ⁴	0.89x10 ⁴	1-9 pc(s)	10-49	50-160	1-9 pc(s)	10-49	50-160	
HFSC5											

Fixed Length Extrusion (1000mm)

⚠ Part numbers beginning with the character "K" indicate Fixed Length Extrusion.

Part Number	L mm	Sectional Area mm ²	Cross Sectional Moment of Inertia mm ⁴		Unit Price Qty. 1 - 19	Volume Discount Rate 20-120
KHFS5	2020	183	0.742x10 ⁴	0.742x10 ⁴		

Fixed Length Extrusion (Effective Length 4000mm P.526)

⚠ Part numbers beginning with the character "K" indicate Fixed Length Extrusion.

Part Number	L mm	Sectional Area mm ²	Cross Sectional Moment of Inertia mm ⁴	ℓx	ℓy	Unit Price 1 - 9 pc(s).	Volume Discount Rate 10-20							
KNFS5	2020	183	0.742x10 ⁴	0.742x10 ⁴	0.742x10 ⁴	1-9 pc(s)	10-20							
KNFSB5 (Black Anodize)														
KHFS5														
KHFSB5 (Black Anodize)														
KCAF5														
KHFSY5														
KNFSF5								4000	(Effective Length)	0.834x10 ⁴	0.746x10 ⁴	0.808x10 ⁴	1-9 pc(s)	10-20
KHFSF5														
KHFSFB5 (Black Anodize)														
KNFST5														
KHFST5	196	0.808x10 ⁴	0.808x10 ⁴	0.808x10 ⁴	0.89x10 ⁴	1-9 pc(s)	10-20							
KHFSTB5 (Black Anodize)														
KHFSH5	199	0.74x10 ⁴	0.89x10 ⁴	0.89x10 ⁴	0.89x10 ⁴	1-9 pc(s)	10-20							
KHFSY5														

Ordering Example	Part Number	L
	HFS5-2020	800
	KHFS5-2020	1000
	KHFSY5-2020	4000

Alterations are available for Configurable Length Extrusions. For details of alterations, see P.755.

5 Series Aluminum Extrusions 20, 25, 40mm Square

2 Slots

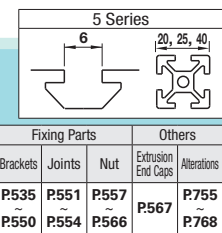

Features: Extrusions with [1x2 slots] and [2x2 slots]. Effective where forces apply.

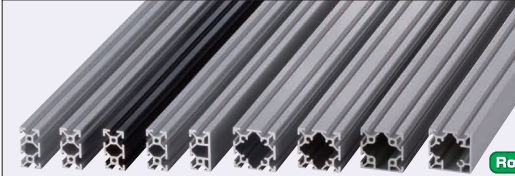

Type		Material	Surface Treatment
Configurable Length	Fixed Length		
NFS_5	KNFS_5	A6063SS-T5	Clear Anodize
NFSB5	KNFSB5		Black Anodize
HFS_5	KHFS_5		Clear Anodize
HFSB5	KHFSB5	EN AC-51400-T5 Equiv.	Black Anodize
CAF5	KCAF5		Clear Coating (Anodize + Clear Coating)
HFSY5	KHFSY5		

⚠ Cut surface and altered parts are not surface treated.

NFS5-2040
NFSB5-2040 (Black Anodize)
HFS5-2040
HFSB5-2040 (Black Anodize)
CAF5-2040 (Clear Coating)

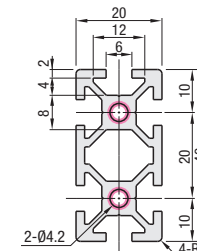

NFSF5-2040
HFSF5-2040

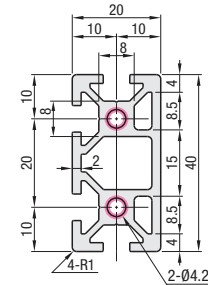

NFS5-4040
NFSB5-4040 (Black Anodize)
HFS5-4040
HFSB5-4040 (Black Anodize)
CAF5-4040 (Clear Coating)

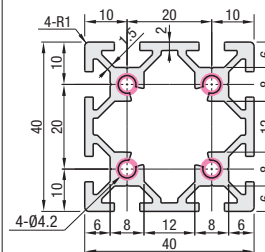

NFSF5-4040
HFSF5-4040

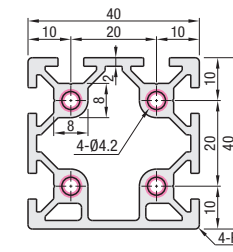

HFST5-4040

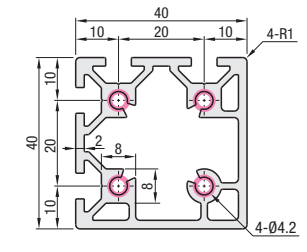

Configurable Length Extrusions

Part Number	L 0.5mm Increment	Mass kg/m	Sectional Area mm ²	Cross Sectional Moment of Inertia mm ⁴		Unit Price (Less than 300mm) 1 - 9 pc(s).	Volume Discount Rate Less Than 300mm		Unit Price/m (300mm or More)	Volume Discount Rate 300mm or More	
				ℓx	ℓy		10-49	50-160		10-49	50-160
NFS5	2040	0.88	324	1.358x10 ⁴	5.13x10 ⁴	1-9 pc(s)	10-49	50-160	1-9 pc(s)	10-49	50-160
NFSB5 (Black Anodize)											
HFS5											
HFSB5 (Black Anodize)											
CAF5 (Clear Coating)											
HFSY5 (Baked Paint, Yellow)											
NFSF5		0.93	344	1.52x10 ⁴	5.40x10 ⁴	1-9 pc(s)	10-49	50-160	1-9 pc(s)	10-49	50-160
HFSF5											
NFS5											
NFSB5 (Black Anodize)											
HFS5											
HFSB5 (Black Anodize)											
CAF5 (Clear Coating)											
HFSY5 (Baked Paint, Yellow)											
NFSF5	1.41	522	9.78x10 ⁴	9.32x10 ⁴	1-9 pc(s)	10-49	50-160	1-9 pc(s)	10-49	50-160	
HFST5											
HFSY5	1.35	497	9.60x10 ⁴	9.60x10 ⁴	1-9 pc(s)	10-49	50-160	1-9 pc(s)	10-49	50-160	
HFST5											

Fixed Length Extrusion (1000mm)

⚠ Part numbers beginning with the character "K" indicate Fixed Length Extrusion.

Part Number	L mm	Sectional Area mm ²	Cross Sectional Moment of Inertia mm ⁴	ℓx	ℓy	Unit Price Qty. 1-19	Volume Discount Rate 20-120
KHFS5	2040	324	1.358x10 ⁴	5.13x10 ⁴			

Fixed Length Extrusion (Effective Length 4000mm P.526)

⚠ Part numbers beginning with the character "K" indicate Fixed Length Extrusion.

Part Number	L mm	Sectional Area mm ²	Cross Sectional Moment of Inertia mm ⁴	ℓx	ℓy	Unit Price 1 - 9 pc(s).	Volume Discount Rate 10-20							
KNFS5	2040	324	1.358x10 ⁴	5.13x10 ⁴	5.13x10 ⁴	1-9 pc(s)	10-20							
KNFSB5 (Black Anodize)														
KHFS5														
KHFSB5 (Black Anodize)														
KCAF5														
KNFSF5								4000	(Effective Length)	1.52x10 ⁴	5.40x10 ⁴	0.808x10 ⁴	1-9 pc(s)	10-20
KHFSF5														
KNFST5														
KHFST5														
KNFSB5 (Black Anodize)								472	8.89x10 ⁴	8.89x10 ⁴	8.89x10 ⁴	0.89x10 ⁴	1-9 pc(s)	10-20
KHFSTB5 (Black Anodize)														
KCAF5	522	9.78x10 ⁴	9.32x10 ⁴	9.32x10 ⁴	0.89x10 ⁴	1-9 pc(s)	10-20							
KNFSY5														
KHFSY5	497	9.60x10 ⁴	9.60x10 ⁴	9.60x10 ⁴	0.89x10 ⁴	1-9 pc(s)	10-20							
KHFSY5														

Ordering Example	Part Number	L
	HFS5-2040	800
	KHFS5-2040	1000
	KHFSY5-2040	4000

Alterations are available for Configurable Length Extrusions. For details of alterations, see P.755.