

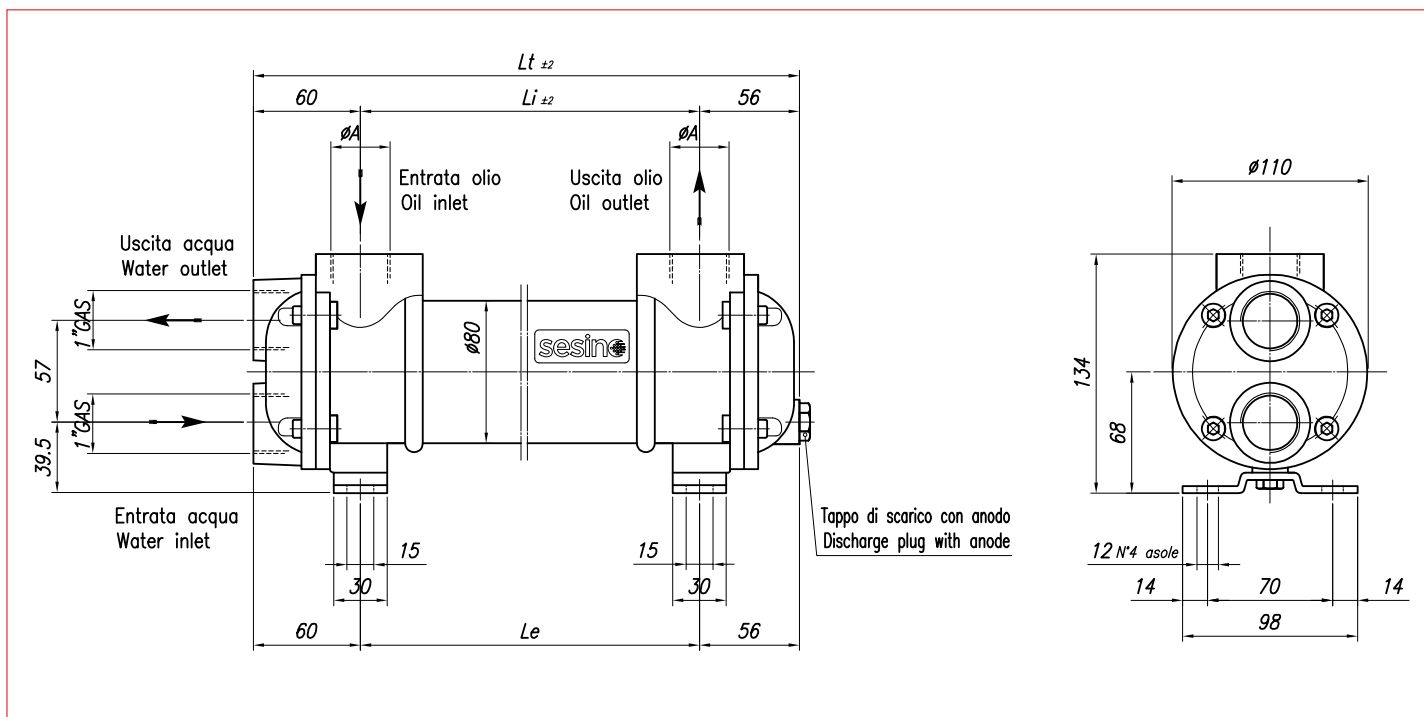

CONSTRUCTION MATERIALS		
SHELL	TUBES	END COVERS
BRASS	CuNi (marine use)	BRONZE
CARBON STEEL	COPPER	CAST IRON
STAINLESS STEEL	STAINLESS STEEL	STAINLESS STEEL

- Dimensions and technical characteristics are not binding

*standard



TYPE	CODE	OIL FLOW l/min	WATER FLOW l/min	kW MIN water flow		kW MAX water flow		WEIGHT kg	DIMENSIONS			
				ΔTm 25° C	ΔTm 25° C	ΔTm 25° C	ΔTm 25° C		ϕA	Li	Le	Lt
MS 84/2 B1	2SC84/2B1CNA	30-80	7,5 - 30	2	3	2,6	4,2	4,5	1" gas	150	150	266
MS 84/2 B2	2SC84/2B2CNA	20-60	7,5 - 30	2,6	4	3,25	5,6	6,3	1" gas	310	310	426
MS 84/2 B3	2SC84/2B3CNA	50-100	7,5 - 30	3,6	4,4	4,6	8	6,5	1 1/2" gas	310	325	441
MS 84/2 B4	2SC84/2B4CNA	30-80	7,5 - 30	4,8	7	6	10	9,0	1" gas	560	560	676
MS 84/2 B5	2SC84/2B5CNA	80-130	7,5 - 30	6	7	7	9	9,0	1 1/2" gas	560	575	691
MS 84/2 B6	2SC84/2B6CNA	40-90	7,5 - 30	9	12	12	18	10,8	1 1/2" gas	715	730	846
MS 84/2 B7	2SC84/2B7CNA	100-160	7,5 - 30	11	14	15	21	10,8	1 1/2" gas	715	730	846
MS 84/2 B8	2SC84/2B8CNA	60-110	7,5 - 30	12	16	16	24	12,3	1 1/2" gas	870	885	1001
MS 84/2 B9	2SC84/2B9CNA	140-190	7,5 - 30	15	17	21	27	12,3	1 1/2" gas	870	885	1001



WATER FLOW RATE:



B1 B2 B3

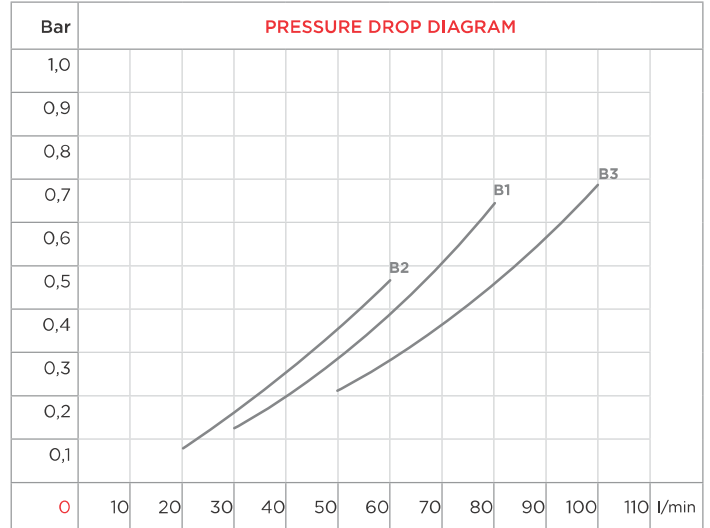
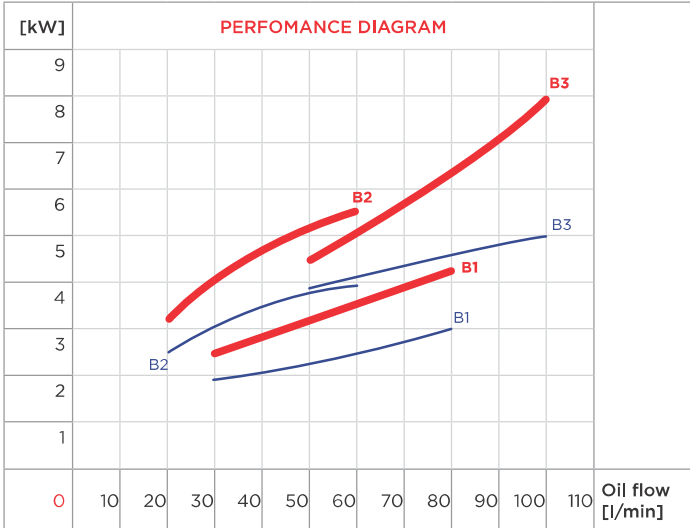

B4 B5 B6

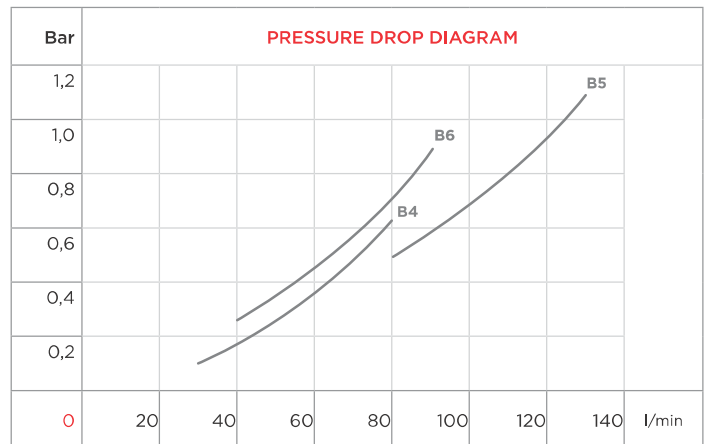
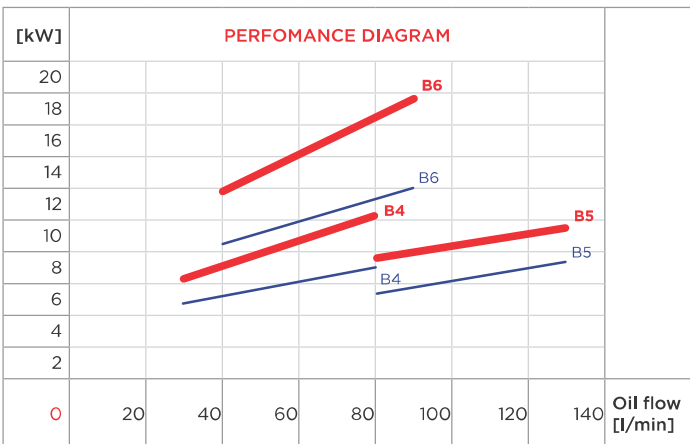

B7 B8 B9

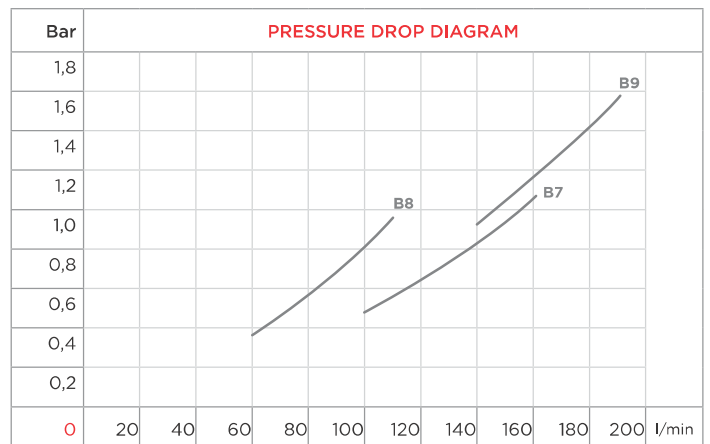
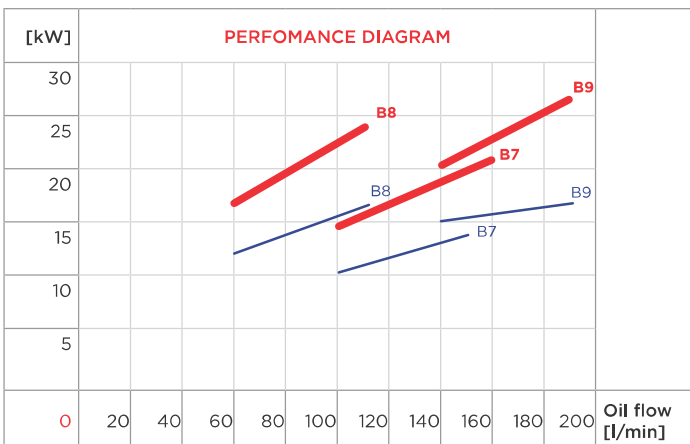

CORRECTION FACTOR							
ΔT_m	10	15	20	25	30	35	40
f	2,5	1,67	1,25	1	0,83	0,71	0,63

CORRECTION FACTOR							
cSt	22	30	46	68	100	150	220
f	0,4	0,6	1	1,5	2,3	3,3	4,6