

OVERALL DIMENSIONS

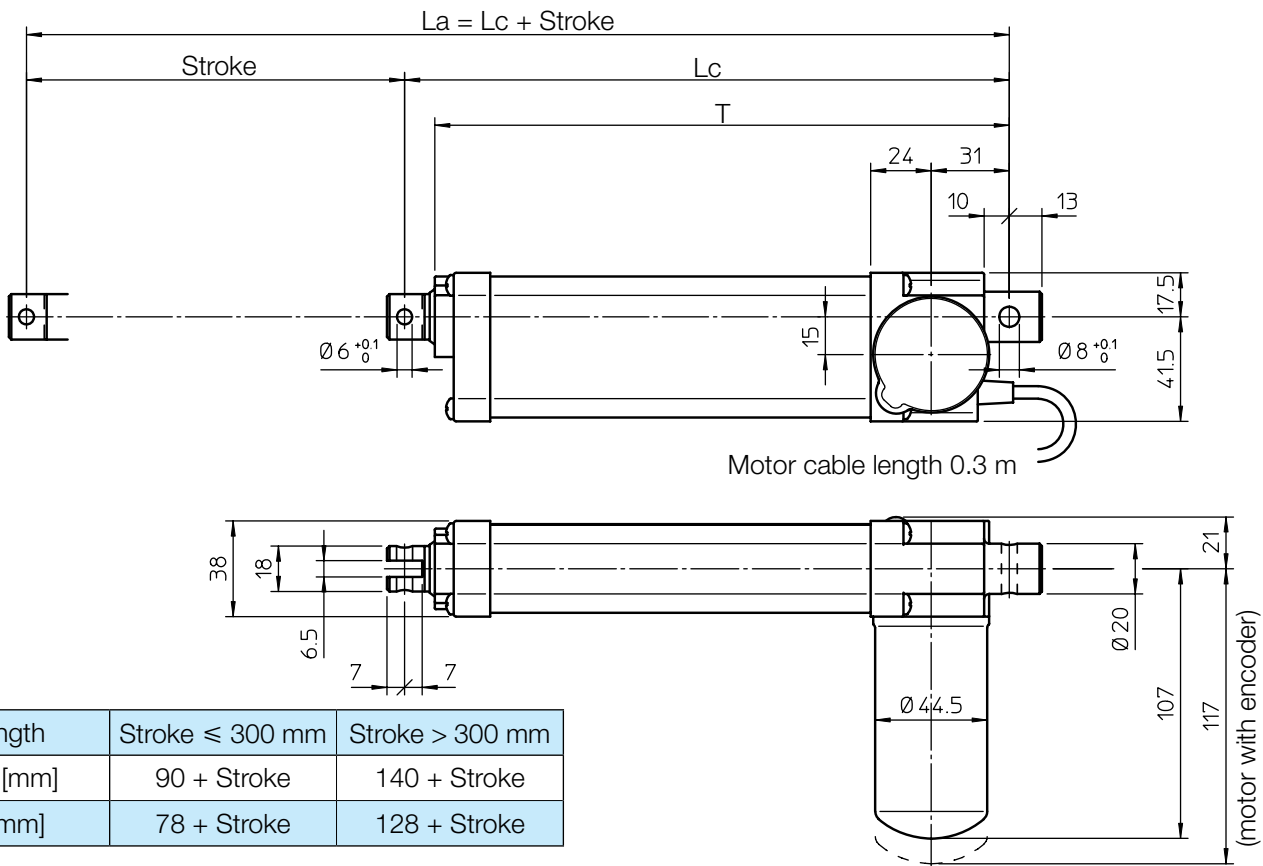

| Length | Stroke \leq 300 mm | Stroke $>$ 300 mm |
|------------|----------------------|-------------------|
| L_c [mm] | 90 + Stroke | 140 + Stroke |
| T [mm] | 78 + Stroke | 128 + Stroke |

| STROKE CODE | STROKE [mm] | LENGTH | | MASS [kg] |
|-------------|-------------|------------|------------|-----------|
| | | L_c [mm] | L_a [mm] | |
| C50 | 50 | 140 | 190 | 0.85 |
| C100 | 100 | 190 | 290 | 1.10 |
| C150 | 150 | 240 | 390 | 1.25 |
| C200 | 200 | 290 | 490 | 1.40 |
| C250 | 250 | 340 | 590 | 1.55 |
| C300 | 300 | 390 | 690 | 1.70 |

PERFORMANCES AND FEATURES

- Pull-Push load up to 1 300 N
- Linear speed up to 52 mm/s
- Standard stroke lengths: 50, 100, 150, 200, 250, 300 mm (min. stroke limited by FC switches: 50 mm) (for different / longer stroke lengths please contact us)
- Aluminium housing and rear attachment
- Anodized aluminium push rod – tolerance f8
- Aluminium front attachment
- 12, 24 or 36 V DC motor with electromagnetic noise suppressor (motor features details on page 69)
- Duty cycle with max load: 15% over 10 min at (-10 ... +40) °C
- Standard motor mounting position as per dimensional drawing (right-hand, code RH)
- Standard protection IP65
 - Test IP6X according to EN 60529 §12 §13.4-13.6
 - Test IPX5 according to EN 60529 §14.2.5 (tests made with not running actuator)
- Long-life lubrication, maintenance free

ACCESSORIES

- Stainless steel push rod (code SS)
- Two adjustable built-in stroke end switches (code FC2)
- Two adjustable built-in stroke end switches, switching off the motor (code FC2X)
- Extra switch for intermediate position (code FC)
- 2-channels incremental encoder on motor shaft
 - 1 ppr (code GI 21)
 - 4 ppr (code GI 24)
 (wiring diagrams on page 75)

| Number of pulses for 100 mm stroke | Ratio | | | |
|------------------------------------|-------|-------|-------|-------|
| | RN2 | RN1 | RL2 | RL1 |
| GI 21 | 192 | 383 | 483 | 967 |
| GI 24 | 767 | 1 533 | 1 933 | 3 867 |

OPTIONS

- Motor mounting position on opposite side (left-hand, code LH)
- Fixing attachment turned at 90° (code RPT 90)

PERFORMANCES with 24 V DC motor

(Performances with 12 V DC motor: same load, linear speed 10 % less, electrical consumption 2 times more)

1-start acme screw Tr 12x3

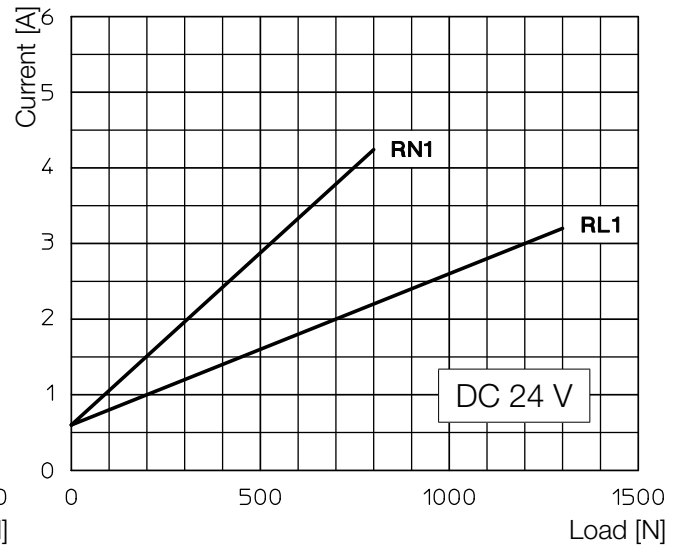
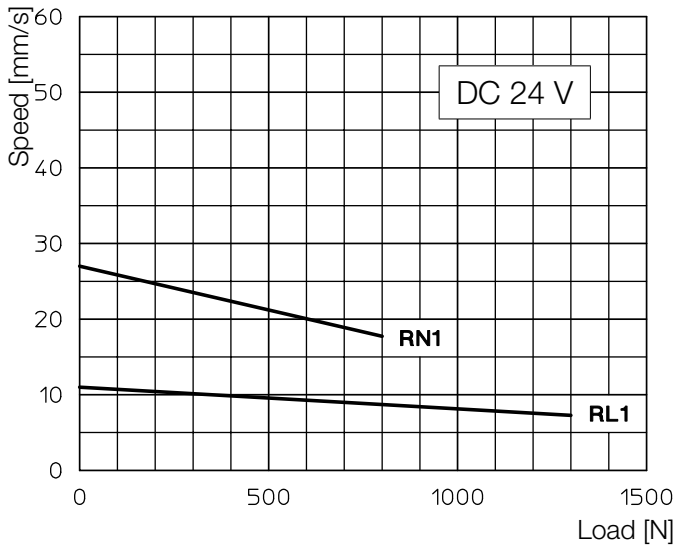

2-starts acme screw Tr 12x6 (P3)

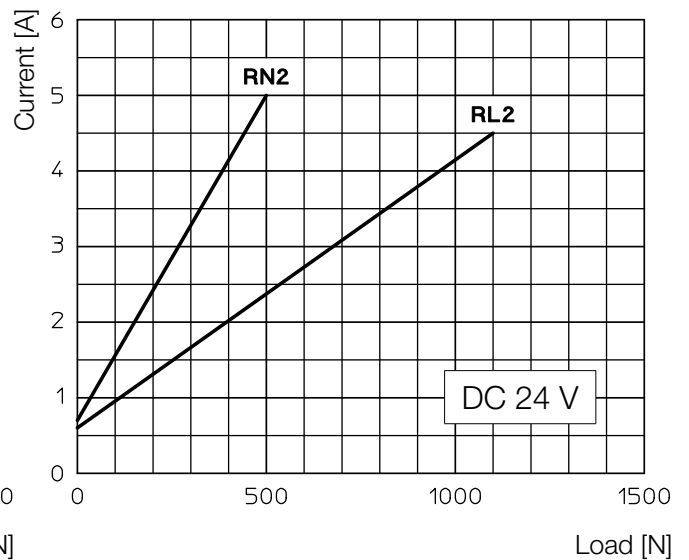
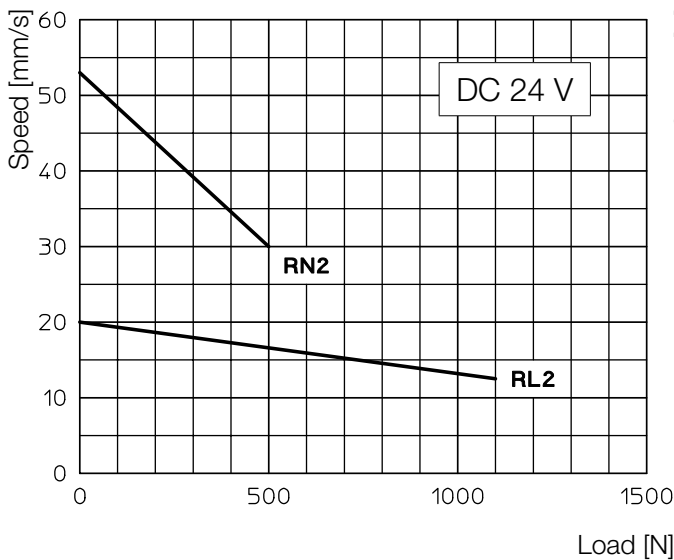

Self-locking conditions

Information about statically self-locking conditions with pull or push load on page 68.

ORDERING CODE EXAMPLE

| | | | | | | | | |
|----------|----------------|-----------------|---------|---------------------|-------------|--|--|---------|
| LMR 01 | RL1 | C200 | CC 24 V | FC2 | | | | |
| Actuator | Selected ratio | Required stroke | Motor | Stroke end switches | Accessories | | | Options |

OVERALL DIMENSIONS

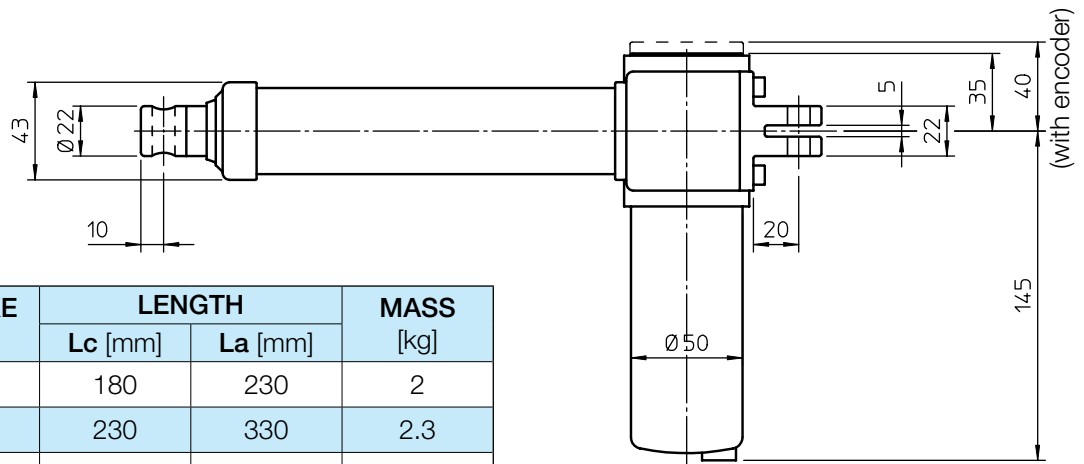
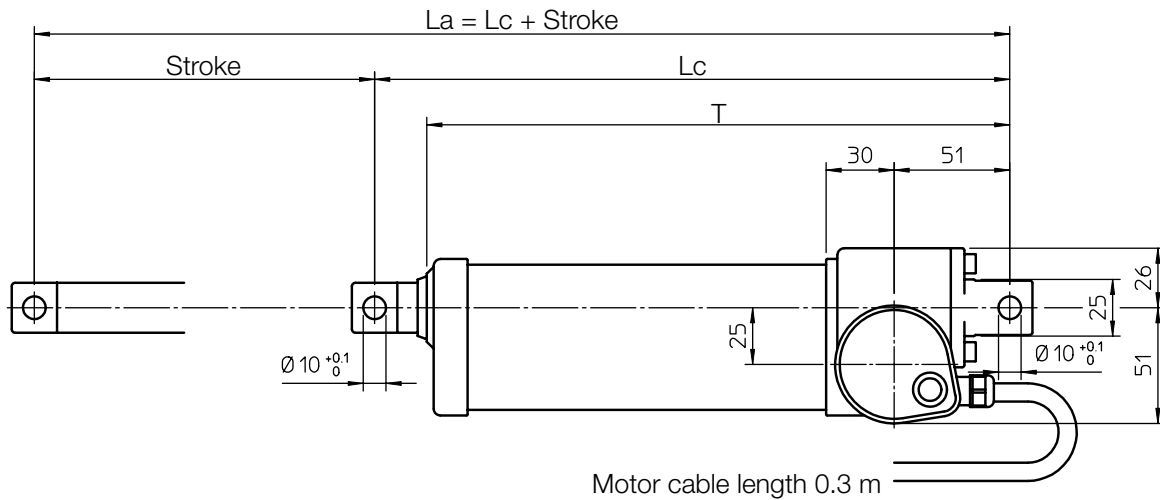

| STROKE CODE | STROKE [mm] | LENGTH | | MASS [kg] |
|-------------|-------------|---------|---------|-----------|
| | | Lc [mm] | La [mm] | |
| C50 | 50 | 180 | 230 | 2 |
| C100 | 100 | 230 | 330 | 2.3 |
| C150 | 150 | 280 | 430 | 2.45 |
| C200 | 200 | 330 | 530 | 2.6 |
| C250 | 250 | 380 | 630 | 2.75 |
| C300 | 300 | 430 | 730 | 2.9 |
| C400 | 400 | 580 | 980 | 3.2 |

| Length | Stroke ≤ 300 mm | Stroke > 300 mm |
|---------|-----------------|-----------------|
| Lc [mm] | 130 + Stroke | 180 + Stroke |
| T [mm] | 107 + Stroke | 157 + Stroke |

PERFORMANCES AND FEATURES

- Pull-Push load up to 3 000 N
- Linear speed up to 41 mm/s
- Standard stroke lengths: 50, 100, 150, 200, 250, 300, 400 mm (min. stroke limited by FC switches: 50 mm) (for different / longer stroke lengths please contact us)
- Aluminium housing and rear attachment
- Chrome-plated steel push rod
- Stainless steel AISI 303 front attachment
- 12, 24 or 36 V DC motor with electromagnetic noise suppressor (motor features details on page 69)
- Duty cycle with max. load: 15% over 10 min at (-10 ... +40) °C
- Standard motor mounting position as per dimensional drawing (right-hand, code RH)
- Standard protection IP55
 - Test IP6X according to EN 60529 §12 §13.4-13.6
 - Test IPX5 according to EN 60529 §14.2.5 (tests made with not running actuator)
- Long-life lubrication, maintenance free

ACCESSORIES

- Stainless steel push rod (code SS)
- Two adjustable built-in stroke end switches (code FC2)
- Two adjustable built-in stroke end switches, switching off the motor (code FC2X)
- Extra switch for intermediate position (code FC)
- 2-channels incremental encoder on motor shaft:
 - 1 ppr (code GI 21)
 - 4 ppr (code GI 24)
 (wiring diagrams on page 75)

| Number of pulses for 100 mm stroke | Ratio | | | |
|------------------------------------|-------|------|------|------|
| | RN2 | RN1 | RL2 | RL1 |
| GI 21 | 246 | 492 | 775 | 1550 |
| GI 24 | 984 | 1968 | 3100 | 6200 |

OPTIONS

- Motor mounting position on opposite side (left-hand, code LH)
- Fixing attachment turned at 90° (code RPT 90)

PERFORMANCES with 24 V DC motor

(Performances with 12 V DC motor: same load, linear speed 10 % less, electrical consumption 2 times more)

1-start acme screw Tr 14x4

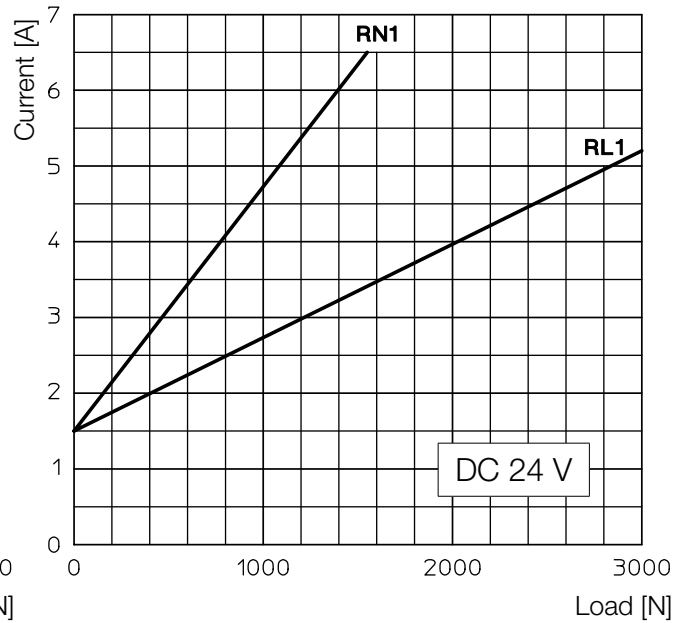
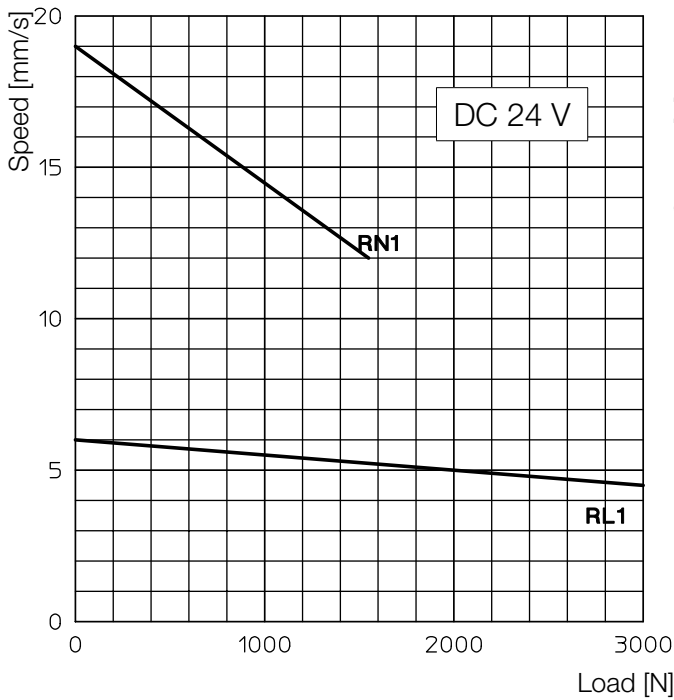

2-starts acme screw Tr 14x8 (P4)

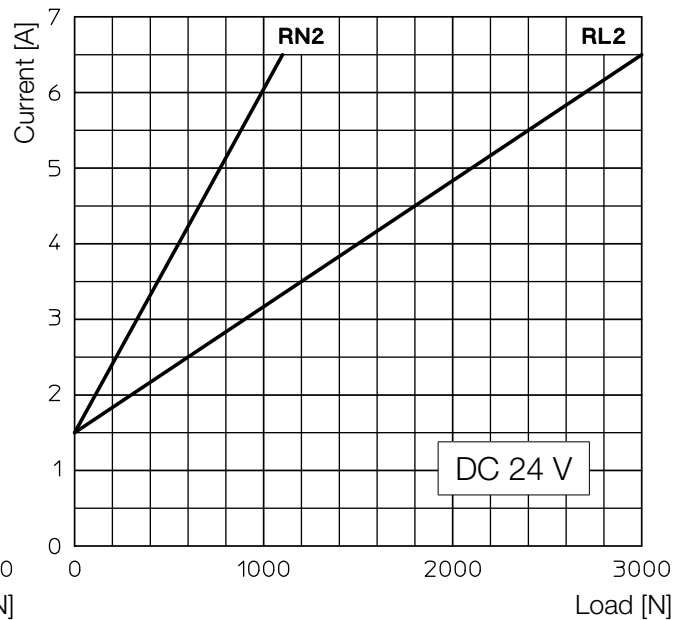
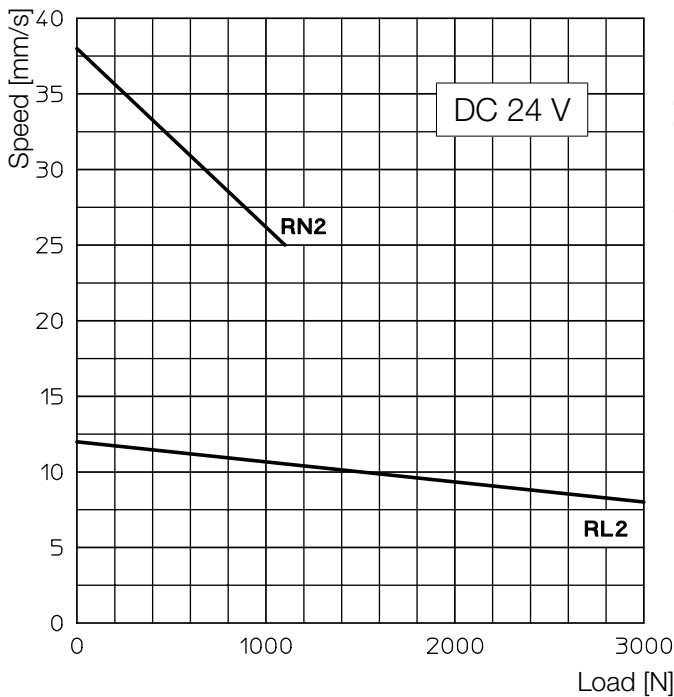

Self-locking conditions

Information about statically self-locking conditions with pull or push load on page 68.

ORDERING CODE EXAMPLE

| | | | | | | | | |
|----------|----------------|-----------------|---------|---------------------|-------------|--|--|---------|
| LMR 02 | RL1 | C200 | CC 24 V | FC2 | | | | |
| Actuator | Selected ratio | Required stroke | Motor | Stroke end switches | Accessories | | | Options |

OVERALL DIMENSIONS

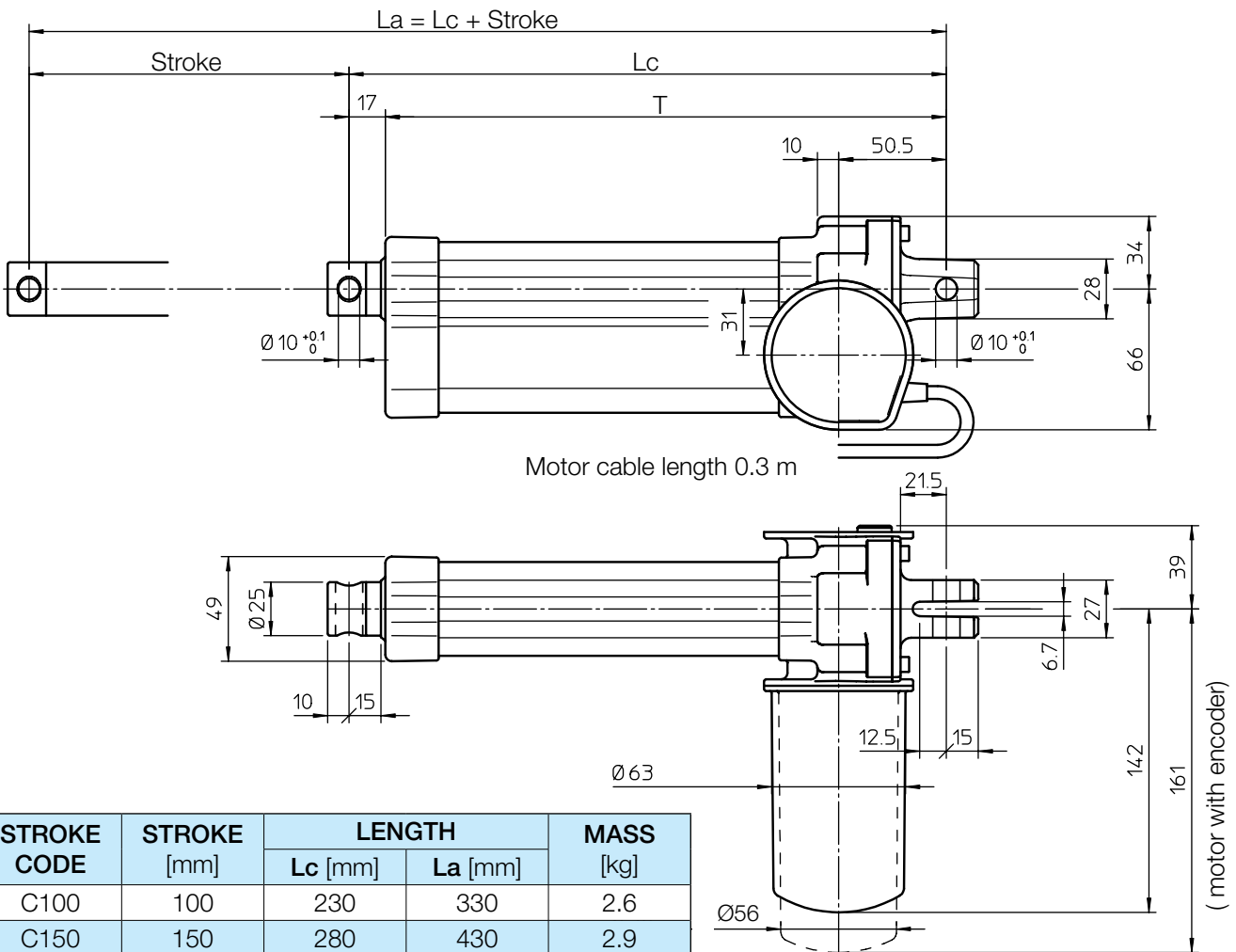

| STROKE CODE | STROKE [mm] | LENGTH | | MASS [kg] |
|-------------|-------------|---------|---------|-----------|
| | | Lc [mm] | La [mm] | |
| C100 | 100 | 230 | 330 | 2.6 |
| C150 | 150 | 280 | 430 | 2.9 |
| C200 | 200 | 330 | 530 | 3.2 |
| C250 | 250 | 380 | 630 | 3.5 |
| C300 | 300 | 430 | 730 | 3.8 |
| C400 | 400 | 580 | 980 | 4.7 |
| C500 | 500 | 680 | 1180 | 5.3 |

| Length | Stroke \leq 300 mm | Stroke $>$ 300 mm |
|---------|----------------------|-------------------|
| Lc [mm] | 130 + Stroke | 180 + Stroke |
| T [mm] | 113 + Stroke | 163 + Stroke |

PERFORMANCES AND FEATURES

- Pull-Push load up to 6 000 N
- Linear speed up to 25 mm/s
- Standard stroke lengths: 100, 150, 200, 250, 300, 400, 500 mm (min. stroke limited by FC switches: 50 mm) (for different / longer stroke lengths please contact us)
- Aluminium housing and rear attachment
- Chrome-plated steel push rod – tolerance f7
- Stainless steel AISI 303 front attachment
- 12, 24 or 36 V DC motor with electromagnetic noise suppressor (motor features details on page 69)
- Duty cycle with max. load: 15% over 10 min at (-10 ... +40) °C
- Standard motor mounting position as per dimensional drawing (right-hand, code RH)
- Standard protection IP65
 - Test IP6X according to EN 60529 §12 §13.4-13.6
 - Test IPX5 according to EN 60529 §14.2.5 (tests made with not running actuator)
- Long-life lubrication, maintenance free

ACCESSORIES

- Stainless steel push rod (code SS)
- Two adjustable built-in stroke end switches (code FC2)
- Two adjustable built-in stroke end switches, switching off the motor (code FC2X)
- Extra switch for intermediate position (code FC)
- 2-channels incremental encoder on motor shaft
 - 1 ppr (code GI 21)
 - 4 ppr (code GI 24)
 (wiring diagrams on page 75)

| Number of pulses for 100 mm stroke | Ratio | | | |
|------------------------------------|-------|-------|-------|-------|
| | RN2 | RN1 | RL2 | RL1 |
| GI 21 | 325 | 650 | 862 | 1 725 |
| GI 24 | 1 300 | 2 600 | 3 450 | 6 900 |

OPTIONS

- Motor mounting position on opposite side (left-hand, code LH)
- Fixing attachment turned at 90° (code RPT 90)

PERFORMANCES with 24 V DC motor

(Performances with 12 V DC motor: same load, linear speed 10 % less, electrical consumption 2 times more)

1-start acme screw Tr 16x4

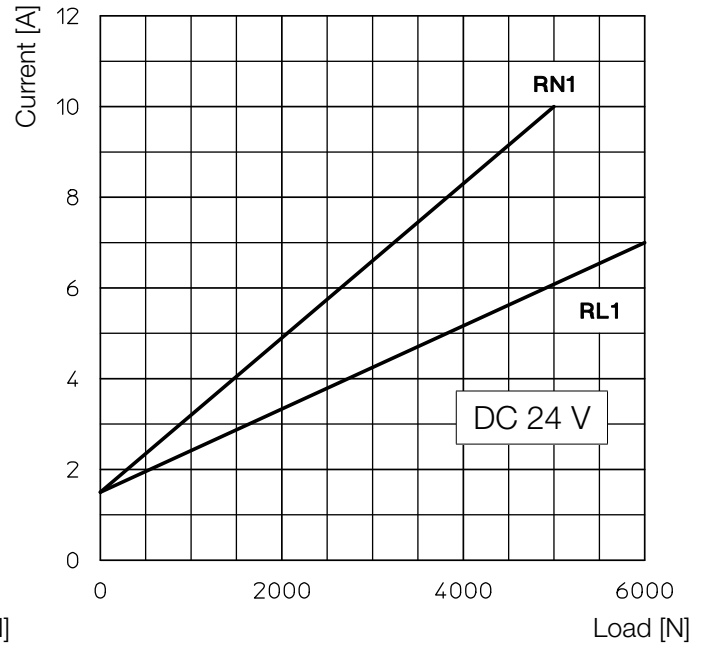
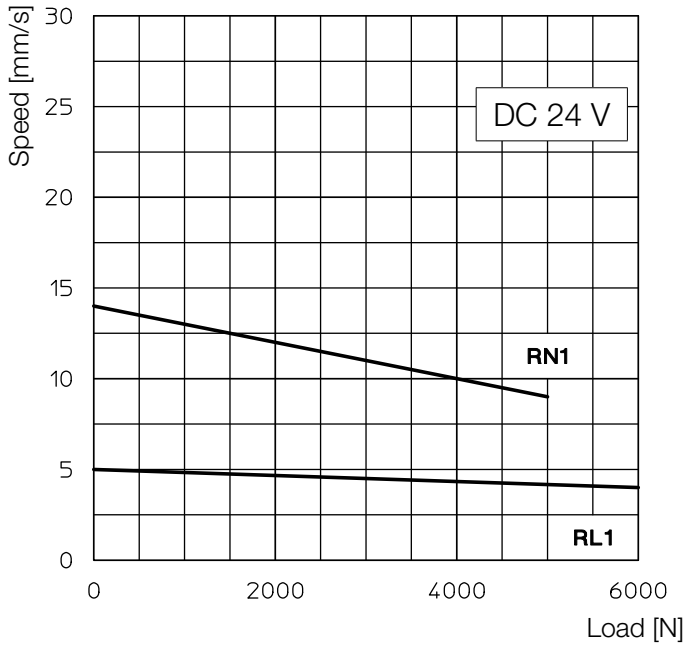

2-starts acme screw Tr 16x8 (P4)

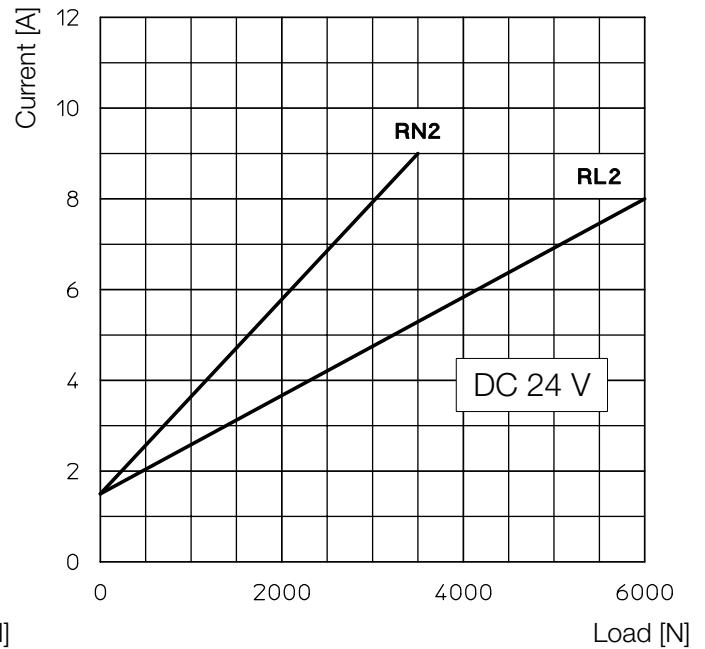
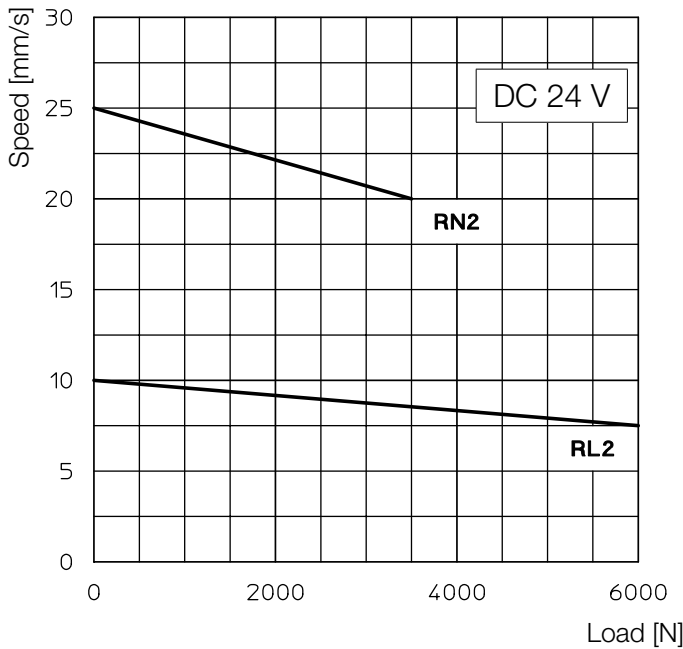

Self-locking conditions

Information about statically self-locking conditions with pull or push load on page 68.

ORDERING CODE EXAMPLE

| | | | | | | | | |
|----------|----------------|-----------------|---------|---------------------|-------------|--|--|---------|
| LMR 03 | RL1 | C200 | CC 24 V | FC2 | | | | |
| Actuator | Selected ratio | Required stroke | Motor | Stroke end switches | Accessories | | | Options |