

# POWER RELAYS RM

Page  
**32**

## POWER RELAYS RM



### SCHRACK-INFO

#### RM 2 / 3 / 7

- 2 / 3 pole 10 / 16 A
- 2 CO or 3 CO contacts
- Switching capacity up to 6000 VA
- DC- or AC-coil
- Mechanical indicator
- Push-to-test button
- Plug-in version, PCB terminals, chassis- or DIN-rail mount

#### RM 5 / 6

- 2 / 3 pole 10 / 16 A
- 2 NO or 3 NO contacts
- DC- or AC-coil
- Push-to-test button
- Plug-in version, PCB terminals, chassis- or DIN-rail mount

#### RM 8

- 2 pole 25 A
- 2 CO contacts
- DC- or AC-coil
- Mechanical indicator
- Push-to-test button
- Chassis- or DIN-rail mount

#### RMD

- 1 pole 30 A, 1 NO or 1 NO + 1 NC contact
- Switching capacity up to 7500 VA
- DC- or AC-coil
- Push-to-test button
- Chassis mount

### TERMINAL ASSIGNMENT

#### RM 2 / 3 / 7

3 CO contacts

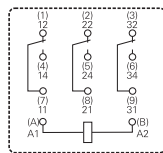

2 CO contacts

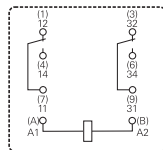

#### RM 5 / 6

3 NO contacts

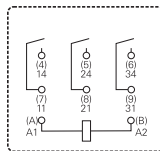

2 NO contacts

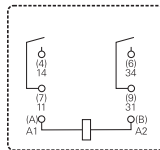

#### RM 8

2 CO contacts

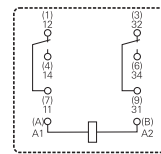

#### RMD

1 NO contact, RMD

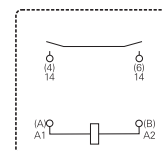

### APPROVALS

VDE REG.-Nr. 40003144, **RU** US E214025

# POWER RELAYS RM

## DIMENSIONS (mm)

COVER WITH MOUNTING BRACKETS, PLUG-IN TERMINALS FOR SOCKET

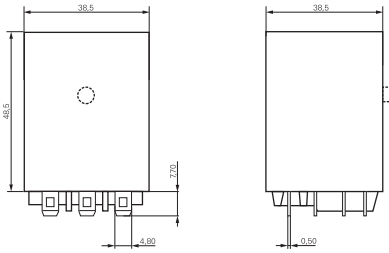

PCB VERSION

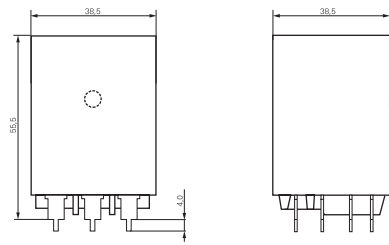

COVER WITH MOUNTING BRACKETS, FASTON 250 (187 FEASIBLE)

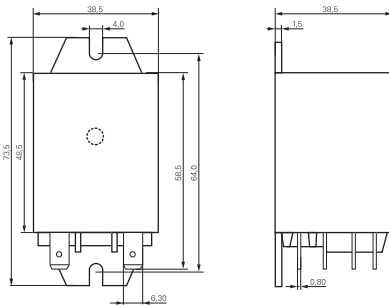

COVER WITH DIN-RAIL MOUNTING DEVICE, (FASTON 250 ONLY)

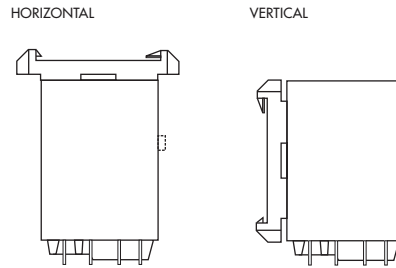

## BREAKING CAPACITY

RM 2, 3, 7

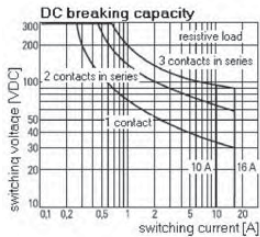

RM 5, 6

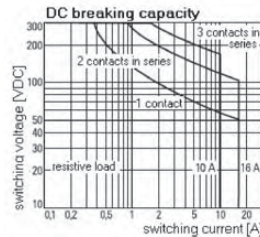

RM 8

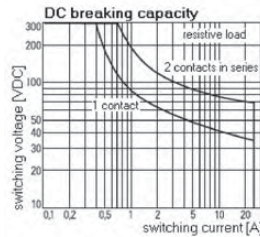

RMD

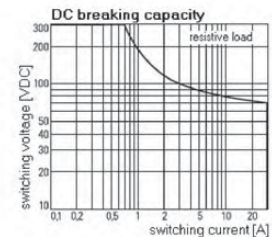

## PRODUCT KEY

Type	<b>RM</b>
Contact configuration	2 2 CO contacts, 16 A 3 3 CO contacts, 10 A 5 2 NO contacts, 16 A (3mm contact gap) 6 3 NO contacts, 10 A (3mm contact gap) 8 2 CO contacts, 25 A D 1 NO contact, 30 A
Version	0 without test button 3 with test button
Enclosure	2 Cover without mounting brackets, AMP-Faston 187 3 Cover with mounting brackets, AMP-Faston 187 5 Cover with mounting brackets, AMP-Faston 250 7 PCB version 8 Cover with DIN-rail mounting device, horizontal, AMP-Faston 250 9 Cover with DIN-rail mounting device, vertical, AMP-Faston 250
Coil	Coil code: please refer to coil versions table, preferred types in bold print
	AMP-Faston 187 = 4,8 x 0,5 mm AMP-Faston 250 = 6,3 x 0,8 mm

## POWER RELAYS RM

Page  
34

## POWER RELAYS RM – CONTINUED

## TECHNICAL DATA

CONTACT DATA		RM2	RM3	RM7
Contact configuration		2 CO	3 CO	3 CO
Contact set		single contact	single contact	single contact
Rated current		16 A	10 A	16 A
Rated voltage / max. switching voltage AC		380 V~ / 440 V~	380 V~ / 440 V~	380 V~ / 440 V~
Max. switching power AC		6000 VA	3800 VA	6000 VA
Limiting making current, max. 4s, ef 10%		40 A	40 A	40 A
Contact material		AgCdO	AgCdO	AgCdO
COIL DATA				
Rated voltage range	DC-coil	6...220 VDC	6...220 VDC	6...220 VDC
	AC-coil	6...400 VDC	6...400 VAC	6...400 VDC
Rated power	DC-coil	1,2 W	1,2 W	1,6 W
	AC-coil	2,3 VA	2,3 VA	2,8 VA
Operate / release voltage, coil resistance at 23°C ambient temperature	24 VDC-coil	18 V / 2,4 V	18 V / 2,4 V	18 V / 2,4 V
	230 VAC-coil	184 V / 92 V	184 V / 92 V	184 V / 92 V

Further technical data on [www.schrack.at](http://www.schrack.at)

CONTACT DATA		RM5	RM6	RM8
Contact configuration		2 NO	3 NO	2 CO
Contact set		single contact	single contact	single contact
Rated current		16 A	10 A	25 A
Rated voltage / max. switching voltage AC		380 V~ / 440 V~	380 V~ / 440 V~	250 V~ / 440 V~
Max. switching power AC		6000 VA	3800 VA	6000 VA
Limiting making current, max. 4s, ef 10%		25 A	25 A	60 A
Contact material		AgCdO	AgCdO	AgCdO
COIL DATA				
Rated voltage range	DC-coil	6...220 VDC	6...220 VDC	6...220 VDC
	AC-coil	6...400 VAC	6...400 VDC	6...400 VDC
Rated power	DC-coil	1,6 W	1,6 W	1,2 W
	AC-coil	2,8 VA	2,8 VA	2,8 VA
Operate / release voltage, coil resistance at 23°C ambient temperature	24 VDC-coil	18 V / 2,4 V	18 V / 2,4 V	18 V / 2,4 V
	230 VAC-coil	184 V / 92 V	184 V / 92 V	184 V / 92 V

Further technical data on [www.schrack.at](http://www.schrack.at)

CONTACT DATA		RMD
Contact configuration		1 NO
Contact set		strap contact
Rated current		30 A
Rated voltage / max. switching voltage AC		250 V~ / 440 V~
Max. switching power AC		7500 VA
Limiting making current, max. 4s, ef 10%		60 A
Contact material		AgCdO
COIL DATA		
Rated voltage range	DC-coil	6...220 VDC
	AC-coil	6...400 VAC
Rated power	DC-coil	1,2 W
	AC-coil	2,8 VA
Operate / release voltage, coil resistance at 23°C ambient temperature	24 VDC-coil	18 V / 2,4 V
	230 VAC-coil	184 V / 92 V

Further technical data on [www.schrack.at](http://www.schrack.at)

## POWER RELAYS RM

CONTACTS	COIL	CONTACT MATERIAL	TYPE	AVAILABLE	STORE	ORDER NO.
3 CO, 10A (for RM-socket)	24V DC	AgCdO	SREL-SL-3-UKE-M1-024G-10			<b>RM332024-D</b>
3 CO, 10A (for RM-socket)	230V AC	AgCdO	SREL-SL-3-UKE-M1-230W-10			RM3327305E
3 NO, 10A, 3mm (for RM-socket)	24V DC	AgCdO	SREL-SL-3-AKE-M1-024G-10			RM632024-A
3 CO, 16A (for RM-socket)	12V DC	AgCdO	SREL-SL-3-UKE-M1-012G-16			RM732012-C
3 CO, 16A (for RM-socket)	24V DC	AgCdO	SREL-SL-3-UKE-M1-024G-16			<b>RM732024-C</b>
3 CO, 16A (for RM-socket)	60V DC	AgCdO	SREL-SL-3-UKE-M1-060G-16			<b>RM732060</b>
3 CO, 16A (for RM-socket)	230V AC	AgCdO	SREL-SL-3-UKE-M1-230W-16			<b>RM732730</b>
3 CO, 16A (for RM-socket)	400V AC	AgCdO	SREL-SL-3-UKE-M1-400W-16			RM732900
3 CO, 16A	24V DC	AgCdO	SREL-LL-3-UKE-M1-024G-16			<b>RM738024-C</b>
3 CO, 16A	230V AC	AgCdO	SREL-LL-3-UKE-M1-230W-16			<b>RM738730-C</b>
3 CO, 16A	230V AC	AgCdO	SREL-SL-3-UKE-M1-230W-16			<b>RM7397305E</b>
2 CO, 25A	24V DC	AgCdO	SREL-SL-2-UKE-M1-024G-25			<b>RM835024</b>
2 CO, 25A	230V AC	AgCdO	SREL-SL-2-UKE-M1-230W-25			<b>RM8357305E</b>
2 CO, 25A	24V DC	AgCdO	SREL-LL-2-UKE-M1-024G-25			<b>RM838024</b>
2 CO, 25A	24V DC	AgCdO	SREL-SL-2-UKE-M1-024G-25			<b>RM839024</b>
2 CO, 25A	230V AC	AgCdO	SREL-SL-2-UKE-M1-230W-25			<b>RM839730</b>
3 NO, 30A	24V DC	AgCdO	LEIST-REL-GS-BRK-30A			<b>RMD05024</b>

 / **Order No. blue:** Stored goods, usually ready for delivery on day of order!