

# LTHS03202\*A01

## Parts list

Issued by: Aftermarket.

Catalogue Number: PL\_LTHS03202\_A01

Rev.04

Date: March '12

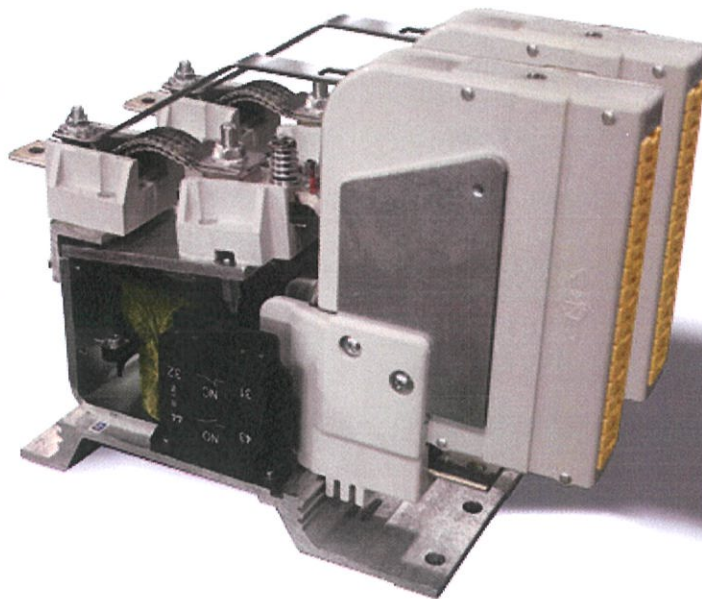

*Microelettrica Scientifica*

# Tavola 1 - Table 1

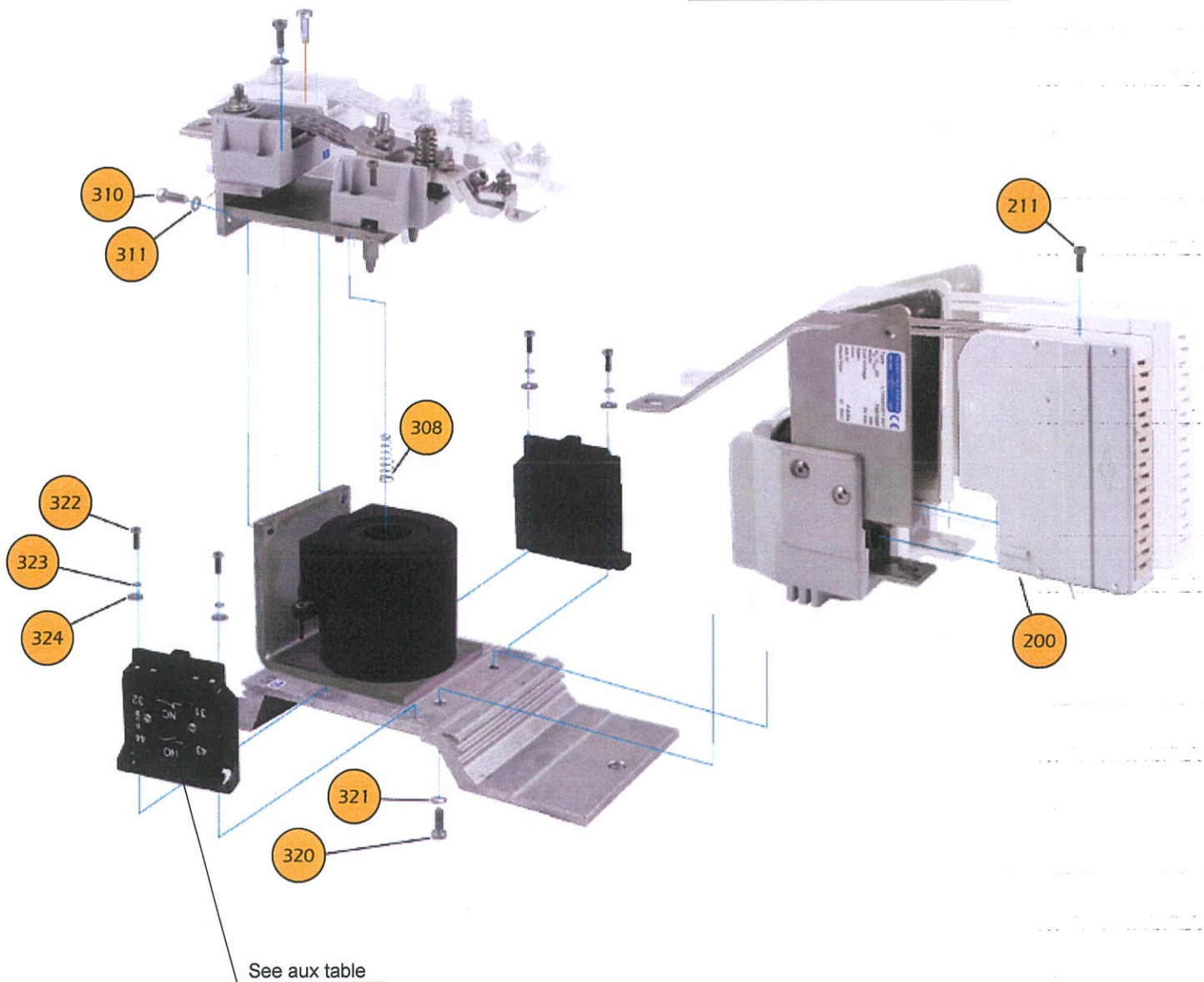
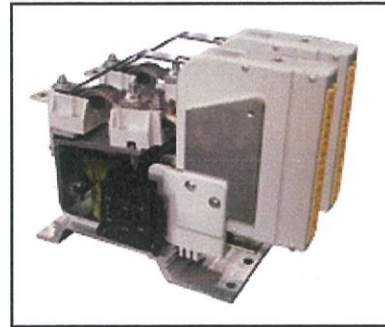

# Tavola 2 - Table 2

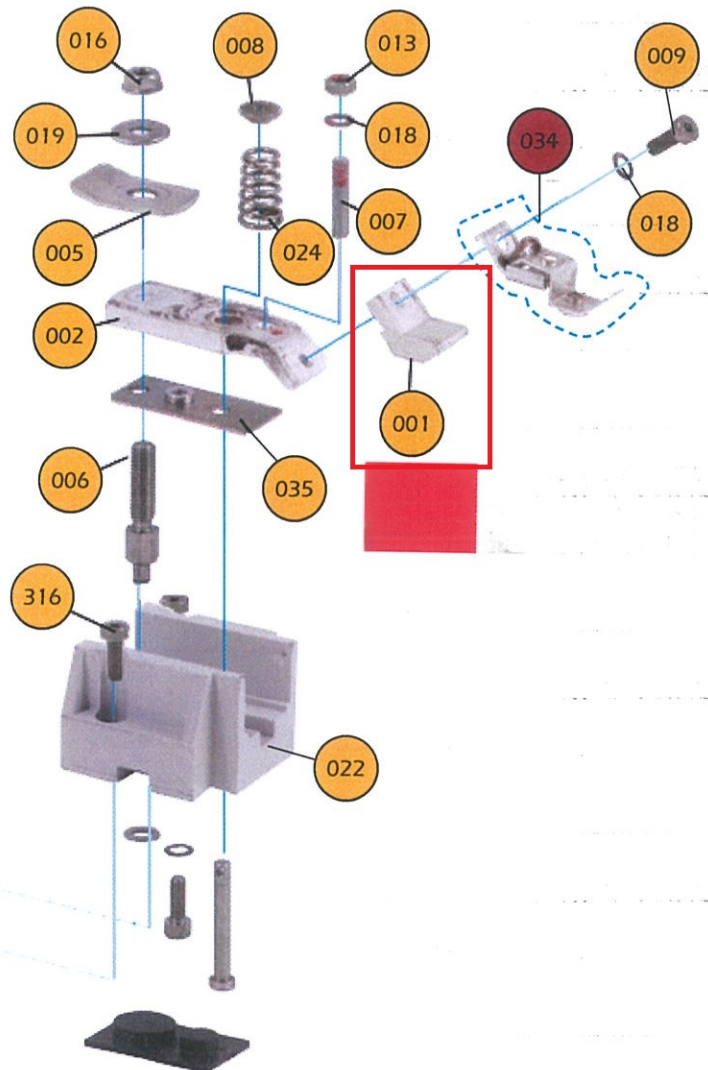
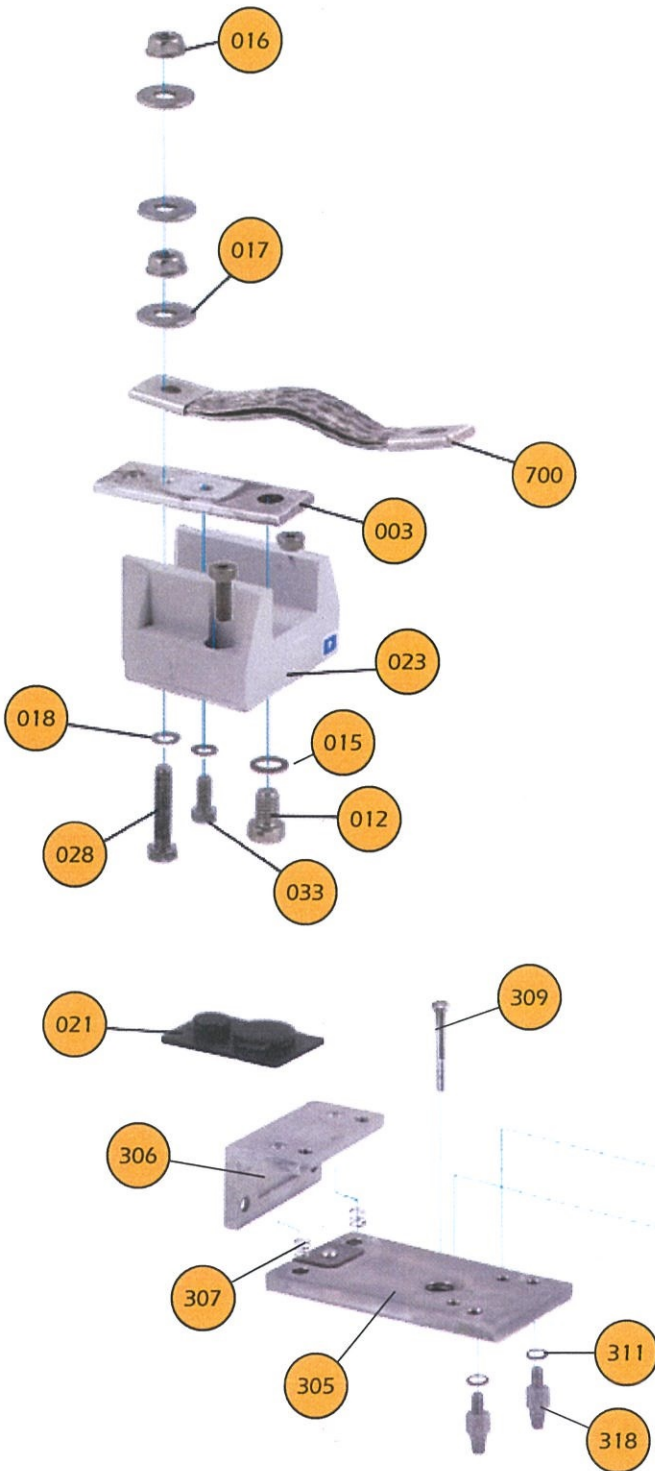
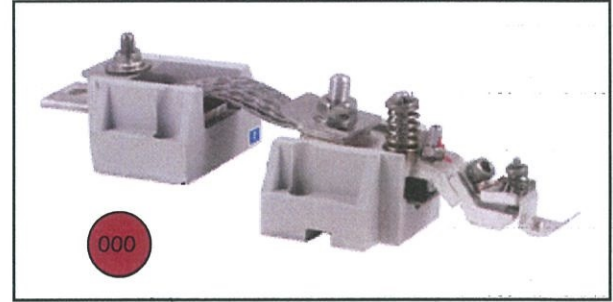

# Tavola 3 - Table 3

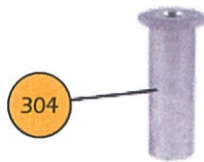
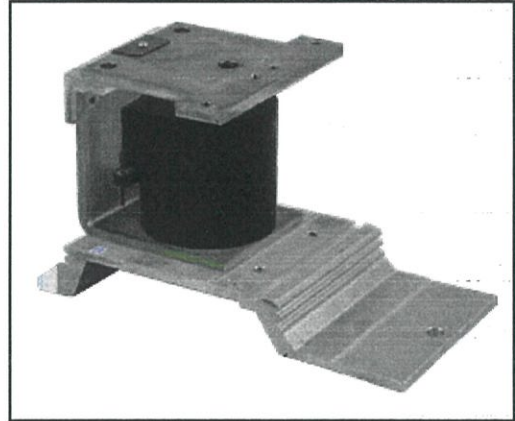

See control coil table

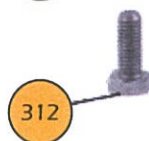
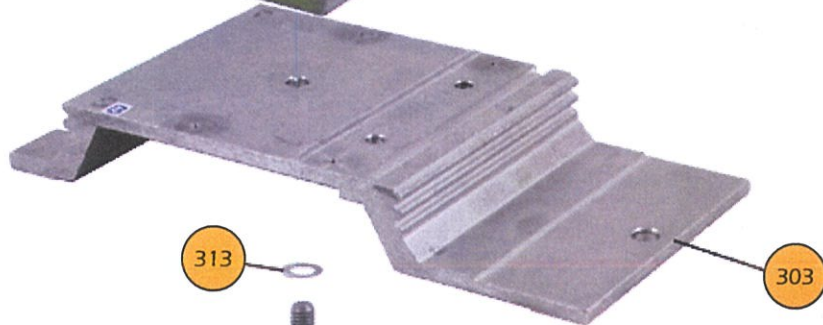
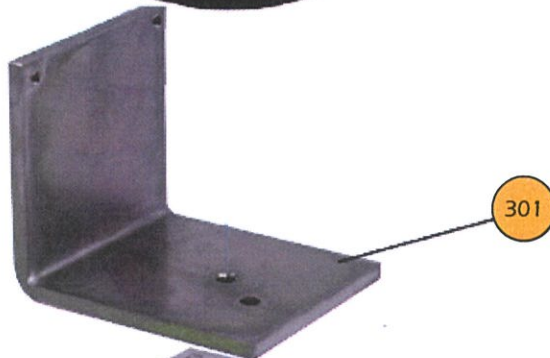

# Tavola 4 - Table 4

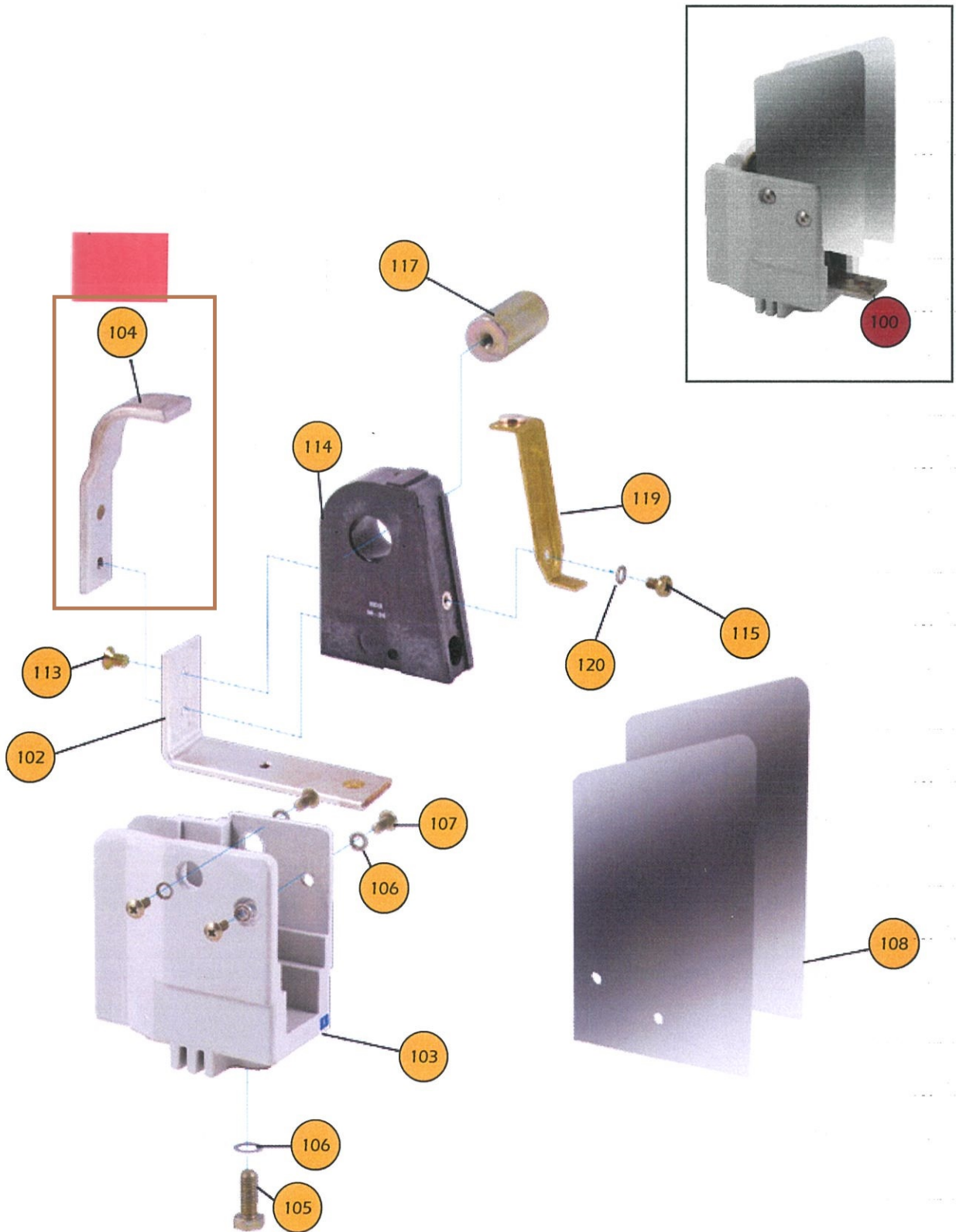

# Tavola 1 - Table 1

#	Descrizione - Description	PN	QTY
200	Caminetto - Arc chute	8640031/1	2
211	Vite M4x12 - Screw M4x12	0510029	1
308	Molla - Spring	0288196	1
310	Vite M5x14- Screw M5x14	0500054	2
311	Rosetta di sicurezza - Lock washer	0594007	1
320	Vite M6x12 - Screw M6x12	0510077	2
321	Rosetta di sicurezza - Lock washer	0594008	1
322	Vite M3x10 - Screw M3x10	0513029	4
323	Rosetta - Flat washer	0590027	4
324	Rosetta di sicurezza - Lock washer	0594004	4

## Tavola 2 - Table 2

#	Descrizione - Description	PN	QTY
000	Polo Mobile - Movable pole	8510548	2
001*	Contatto mobile - Movable contact	0100093/S6	1
002	Porta contatto mobile - Movable contact Bracket	0106167	1
003	Attacco inferiore - Lower attachment	0207934	1
005	Copritreccia - Flexible connection (braid) cap	0135008	1
006	Perno - Pin	0213499	1
007	Vite speciale - Special screw	0217839	1
008	Coppiglia - Split pin	0620010	1
009	Vite M5X14 - Screw M5X14	0510053	1
013	Dado M5 - M5 Nut	0580033	1
015	Rosetta di sicurezza - Lock washer	0594009	1
016	Dado M8 - Nut M8	0582006	1
017	Rosetta - Flat washer	0591002	3
018	Rosetta di sicurezza - Lock washer	0594007	1
019	Rosetta - Flat washer	0590007	1
021	Coperchio - Cover	1366709	2
022	Basetta supporto - Support Bracket	1386635	1
023	Basetta Supporto - Support bracket	1387871	1
024	Molla - Spring	0282159/S	1
028	Vite M6X30 - Screw M6X30	0500085	1
033	Vite M5x12 - Screw M5x12	0511028	1
034**	Gruppo contatto d'arco mobile - Movable arcing contact assembly	0138214/S6	1
035	Piastrina - Plate	0118048	1
305	Nucleo mobile - Movable core	0118225	1
306	Cerniera - Bracket	0127932	1
307	Molla - Spring	0281745	1
309	Vite speciale - Special Screw	0249145	1
311	Rosetta di sicurezza - Lock washer	0594007	1
316	Vite M5X14 - Screw M5X14	0511029	6
318	Insero filettato - Threaded pin	0217950	2
700	Treccia - Flexible connection (braid)	8590037	1

## Tavola 3 - Table 3

#	Descrizione - Description	PN	QTY
301	Nucleo fisso - Fixed core	02111052	1
303	Staffa - Fixing plate	0229072	1
304	Nucleo - Core	0217928	1
312	Vite M8x20 - Screw M8x20	0500106	1
313	Rosetta di sicurezza - Lock washer	0594009	1



## Tavola 4 - Table 4

#	Descrizione - Description	PN	QTY
100	Polo fisso - Fixed pole	8500552	2
102	Squadretta - Bracket	02012437	1
103	Supporto - Bracket	1387927	1
104*	Contatto fisso - Fixed contact	0100108/S6	1
105	Vite M5x12 - Screw M5x12	0511028	1
106	Rosetta di sicurezza - Lock washer	0594007	1
107	Vite M5x6 - Screw M5x6	0217608	2
108	Espansione polare - Magnetic side plate	0118404/D	1
113	Vite M5x8 - screw M5x8	0522077	1
114	Bobina - Control coil	8583150	1
115	Vite M4x16 - Screw M4x16	0513051	1
117	Nucleo bobina di soffio - Blow-out Control coil core	0217208	1
119**	Gruppo contatto d'arco fisso - Fixed arcing contact assembly	0138897/S6	1
120	Rosetta di sicurezza - Lock washer	0594006	1