

LMK 351

Screw-in Transmitter

Ceramic Sensor

accuracy according to IEC 60770:
standard: 0.35% FSO
option: 0.25% FSO



Nominal pressure

from 0 ... 40 mbar up to 0 ... 20 bar

Output signal

2-wire: 4 ... 20 mA
3-wire: 0 ... 20 mA / 0 ... 10 V
others on request

Product characteristics

- ▶ pressure port PVDF-version for aggressive media
- ▶ pressure port G 1 1/2" for pasty and polluted media



Optional versions

- ▶ IS-version
Ex ia = intrinsically safe for gases and dust
- ▶ diaphragm 99.9 % Al₂O₃
- ▶ customer specific versions



The screw-in transmitter LMK 351 has been designed for measuring small system pressure and level measurement in container. The LMK 351 is based on an own-developed capacitive ceramic sensor element. Usage in viscous and pasty media is possible because of the flush mounted sensor.

For the usage in aggressive media a pressure port in PVDF and the diaphragm in Al₂O₃ 99.9 % is available. An intrinsically safe version completes the range of possibilities.

Preferred areas of use are

-  Plant and machine engineering
-  Environmental engineering
(water – sewage – recycling)

Preferred used for

-  Fuel and oil
-  Viscous and pasty media

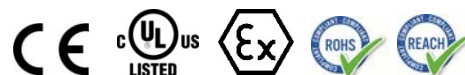

Pressure ranges																
Nominal pressure	[bar]	0.04	0.06	0.1	0.16	0.25	0.4	0.6	1	1.6	2.5	4	6	10	16	20
Level	[mH ₂ O]	0.4	0.6	1	1.6	2.5	4	6	10	16	25	40	60	100	160	200
Overpressure	[bar]	2	2	4	4	6	6	8	8	15	25	25	35	35	45	45
Permissible vacuum	[bar]	-0.2		-0.3		-0.5								-1		

Output signal / Supply	
Standard	2-wire: 4 ... 20 mA / V _S = 9 ... 32 V _{DC}
Option Ex-version	2-wire: 4 ... 20 mA / V _S = 14 ... 28 V _{DC}
Option 3-wire	3-wire: 0 ... 10 V / V _S = 12.5 ... 32 V _{DC}

Performance	
Accuracy ¹	standard: ≤ ± 0.35 % FSO option for P _N ≥ 0.6 bar: ≤ ± 0.25 % FSO
Permissible load	current 2-wire: R _{max} = [(V _S - V _{S min}) / 0.02 A] Ω voltage 3-wire: R _{min} = 10 kΩ
Influence effects	supply: 0.05 % FSO / 10 V load: 0.05 % FSO / kΩ
Long term stability	≤ ± 0.1 % FSO / year at reference conditions
Turn-on time	700 msec
Mean measuring time	5/sec
Response time	mean response time: ≤ 200 msec max. response time: 380 msec

¹ accuracy according to IEC 60770 - limit point adjustment (non-linearity, hysteresis, repeatability)

Thermal effects (Offset and Span) / -Permissible temperatures			
Tolerance band	≤ ± 0.1 % FSO / 10 K	in compensated range - 20 ... 80 °C	
Permissible temperatures ²	medium: -40 ... 125 °C	electronics / environment: -40 ... 85 °C	storage: -40 ... 100 °C

² for pressure port of PVDF the minimum permissible temperature is -30 °C

Electrical protection	
Short-circuit protection	permanent
Reverse polarity protection	no damage, but also no function
Electromagnetic compatibility	emission and immunity according to EN 61326

Mechanical stability	
Vibration	10 g RMS (20 ... 2000 Hz) according to DIN EN 60068-2-6
Shock	100 g / 1 msec according to DIN EN 60068-2-27

Materials (media wetted)	
Pressure port	standard: stainless steel 1.4404 (316L) option: PVDF
Housing	standard: stainless steel 1.4404 (316L) option: PVDF
Seals	FKM -40 ... 125 °C FFKM -15 ... 125 °C EPDM -40 ... 125 °C
Diaphragm	standard: ceramics Al ₂ O ₃ 96 % options: ceramics Al ₂ O ₃ 99.9 %
Media wetted parts	pressure port, seals, diaphragm

Explosion protection (only for 4 ... 20 mA / 2-wire)	
Approval DX14-LMK 351	IBExU05ATEX1070 X stainless steel-pressure port with connector: zone 0: II 1G Ex ia IIC T4 Ga zone 20: II 1D Ex ia IIIC T85 °C Da plastic-pressure port with connector: zone 0/1 ³ : II 1/2G Ex ia IIC T4 Ga/Gb zone 20/21 ⁴ : II 1/2D Ex ia IIIC T85 °C Da/Db
Safety technical maximum values	U _i = 28 V, I _i = 93 mA, P _i = 660 mW, C _i = 27 nF, L _i = 5 μH, C _{gnd} = 27 nF
Max. permissible temperature for environment	in zone 0: -20 ... 60 °C for p _{atm} 0.8 bar up to 1.1 bar zone 1 and higher: -25 ... 70 °C
Connecting cables (by factory)	capacity: signal line / shield also signal line / signal line: 160 pF/m inductance: signal line / shield also signal line / signal line: 1 μH/m

³ The designation depends on the used pressure range. With nominal pressure ranges ≤ 60 mbar the designation is „2G“.
⁴ With nominal pressure ranges > 60 mbar and < 10 bar (see item 17 of the type-examination certificate) must be attended!

Miscellaneous	
Current consumption	signal output current: max. 21 mA signal output voltage: max. 5 mA
Weight	approx. 200 g
Installation position	any
Operational life	100 million load cycles
CE-conformity	EMV-directive: 2014/30/EU
ATEX Directive	2014/34/EU

LMK 351

Screw-in Transmitter

Technical Data

Wiring diagram

2-wire-system (current)

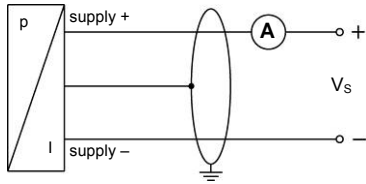

3-wire-system (voltage)

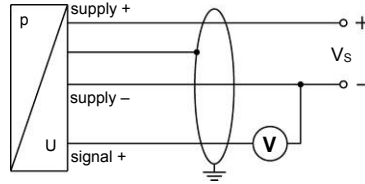

Pin configuration

Electrical connection	ISO 4400	Binder 723 (5-pin)	M12x1 (4-pin)	field housing	cable colours (IEC 60757)
Supply +	1	3	1	IN +	wh (white)
Supply -	2	4	2	IN -	bn (brown)
Signal + (only for 3-wire)	3	1	3	OUT +	gn (green)
Shield	ground pin	5	4	⊥	gnye (green-yellow)

Electrical connections (dimensions in mm)

standard

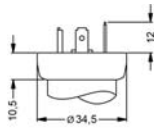

ISO 4400 (IP 65)

option

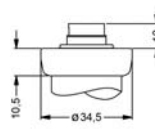

Binder Series 723 5-pin (IP 67)

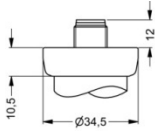

M12x1 4-pin (IP 67)

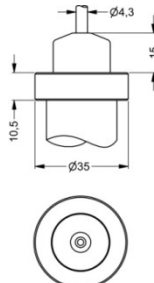

cable outlet with PVC cable (IP 67)⁴

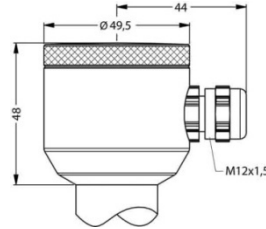

compact field housing (IP 67)

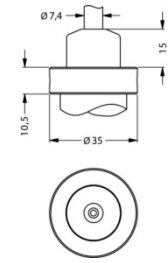

cable outlet, cable with ventilation tube (IP 68)⁵

⁴ standard: 2 m PVC cable without ventilation tube (permissible temperature: -5 ... 70 °C)

⁵ different cable types and lengths available, permissible temperature depends on kind of cable

Dimensions (in mm)

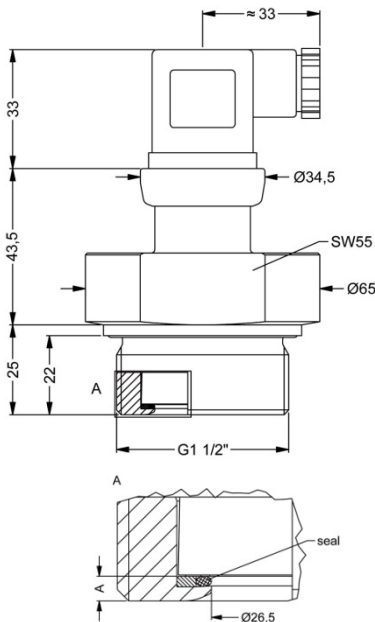

G1 1/2" flush (DIN 3852) stainless steel

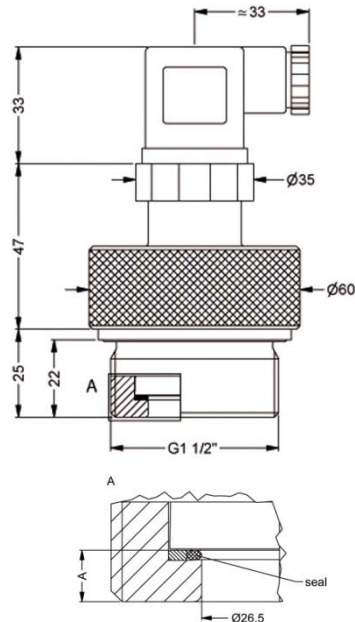

G1 1/2" flush (DIN 3852) PVDF⁶

material	A
stainless steel	ca. 3
PVDF	ca. 6

⁶ not possible in combination with compact field housing

© 2018 BD|SENSORS GmbH – The specifications given in this document represent the state of engineering at the time of publishing. We reserve the right to make modifications to the specifications and materials.

Ordering code LMK 351

LMK 351

□□□□ - □□□□ - □ - □ - □□□□ - □□□□ - □ - □ - □□□□

Pressure																			
	in bar	4	7	0															
	in mH ₂ O	4	7	1															
Input		[mH ₂ O]	[bar]																
	0.4	0.04		0	4	0	0												
	0.6	0.06		0	6	0	0												
	1.0	0.10		1	0	0	0												
	1.6	0.16		1	6	0	0												
	2.5	0.25		2	5	0	0												
	4.0	0.40		4	0	0	0												
	6.0	0.60		6	0	0	0												
	10	1.0		1	0	0	1												
	16	1.6		1	6	0	1												
	25	2.5		2	5	0	1												
	40	4.0		4	0	0	1												
	60	6.0		6	0	0	1												
	100	10		1	0	0	2												
	160	16		1	6	0	2												
	200	20		2	0	0	2												
	customer			9	9	9	9												consult
Output																			
	4 ... 20 mA / 2-wire																		1
	0 ... 10 V / 3-wire																		3
	Intrinsic safety 4 ... 20 mA / 2-wire																		E
	customer																		9
																			consult
Accuracy																			
	standard	0.35 %																	3
	option for P _N ≥ 0.6 bar:	0.25 %																	2
	customer																		9
																			consult
Electrical connection																			
	Male and female plug ISO 4400																		1 0 0
	Male plug Binder series 723 (5-pin)																		2 0 0
	Cable outlet with PVC- cable ¹																		T A 0
	Cable outlet ²																		T R 0
	Male plug M12x1 (4-pin) / metal																		M 1 0
	compact field housing																		8 5 0
	customer																		9 9 9
																			consult
Mechanical connection																			
	G1 1/2" DIN 3852 with flush sensor																		M 0 0
	customer																		9 9 9
																			consult
Seals																			
	FKM																		1
	EPDM																		3
	FFKM																		7
	customer																		9
																			consult
Pressure port																			
	Stainless steel 1.4404 (316L)																		1
	PVDF ³																		B
	customer																		9
																			consult
Diaphragm																			
	Ceramics Al ₂ O ₃ 96%																		2
	Ceramics Al ₂ O ₃ 99.9%																		C
	customer																		9
																			consult
Special version																			
	standard																		0 0 0
	customer																		9 9 9
																			consult

¹ standard: 2 m PVC cable without ventilation tube (permissible temperature: -5 ... 70 °C)
² cable with ventilation tube (code TR0 = PVC cable), different cable types and lengths available, price without cable
³ not possible in combination with compact field housing; min. permissible temperature -30 °C

This document contains product specification; properties are not guaranteed. Detailed information about options are defined in the datasheet. Subject to change without notice.

