

## Datasheet - IFL 8-18-10N

Inductive proximity switch / Housing construction form: cylinder, thread / IFL - M18



- Design M 18 x 1
- Metal enclosure
- DC 3-wire

(Minor differences between the printed image and the original product may exist!)

### Ordering details

Product type description	IFL 8-18-10N
Article number	101140423
EAN code	4030661118789
eCl@ss	27-27-01-01

### Global Properties

Product name	IFL - M18
Standards	IEC/EN 60947-5-2; DIN VDE 0660-208
Compliance with the Directives (Y/N) 	Yes
Operating resource protection class	None
Materials	
- Material of the housings	Brass
- Material of the nuts	Brass
- Material of the cable mantle	PVC
- Material of the active surface	Plastic
Housing coating	nickel-plated
Housing construction form	cylinder, thread
Weight	90 g

### Mechanical data

Design of electrical connection	Cable
---------------------------------	-------

Cable length	2 m
Conductor with strain relief	No
Conductors	3 x 0,14 mm <sup>2</sup>
mechanical installation conditions	not flush
Switch distance	8 mm
Reduction factor 1 met (Y/N)	No
Protection circuit	inductive interference protection, Protection against polarity reversal, short-circuit and overload proof
Pressure resistant (Y/N)	No
Tightening torque for nuts	A/F 24 max. 1800 Ncm

### Ambient conditions

---

Ambient temperature	
- Min. environmental temperature	-25 °C
- Max. environmental temperature	+70 °C
Protection class	IP67 to IEC/EN 60529

### Electrical data

---

Design of control element	Normally open contact (NO)
Number of wire	3 piece
Voltage type	DC, direct current
Supply voltage U <sub>B</sub>	
- Min. supply voltage	10 V
- Max. supply voltage	30 V
Switch frequency	approx. 400 Hz
Voltage drop U <sub>d</sub>	approx. 1.2 V (200 mA)
Operating current I <sub>e</sub>	200 mA
No-load current I <sub>0</sub>	approx. 3.4 mA (24 V)

### Outputs

---

Design of control output	NPN
--------------------------	-----

### LED switching conditions display

---

LED switching conditions display (Y/N)	Yes
- yellow LED	

### ATEX

---

Explosion protection categories for gases	None
Explosion protected category for dusts	None

### Dimensions

---

Dimensions of the sensor	
- Length of sensor	53 mm
- Diameter of sensor	M18

### notice



---

Instead of nuts, a mounting clamp can be provided.

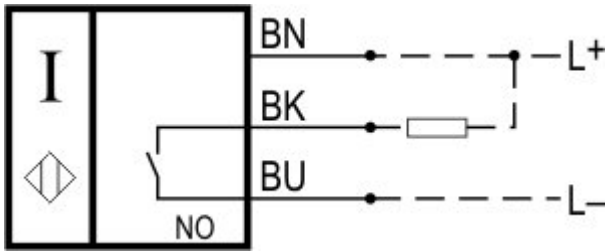
## Diagram

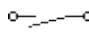
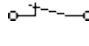

Note Diagram

-  positive break NC contact
-  active
-  no active
-  Normally-open contact
-  Normally-closed contact

## Ordering code

IFL (1)-(2)(3)-(4)(5)(6)(7)-(8)

(1)

5

Switch distance 5 mm

8

Switch distance 8 mm

10

Switch distance 10 mm

(2)

18

cylinder, thread M18, Metal film

180

cylinder, thread M18, Plastic

(3)

*without*

Included in standard version Design

M

miniature body

L

Long design

(4)

01

Opener (NC)

10

Normally open contact (NO)

10/01

Normally open contact (NO) / Opener (NC) with Wiring compartment

11

Normally open contact (NO) / Opener (NC) antivalent

(5)

*without*

Cable

ST

Connector

T

Conductor with strain relief

A

Alternating current/direct current AC/DC

D

DC 2-wire

(6)

*without*

Included in standard version Plug-in connection

2

Alternative Plug-in connection

(7)

N

n-type

P

p-type

(8)

2033

Stainless steel enclosure

2130

Max. +130°C, without LED switching conditions display

## Documents

---

**Mounting and wiring instructions** (de, en, fr, it) 79 kB, 05.10.2010

Code: m\_fl1p01

**Declaration of conformity** (en, de) 232 kB, 05.11.2013

Code: \_\_iflp01

## Images

---

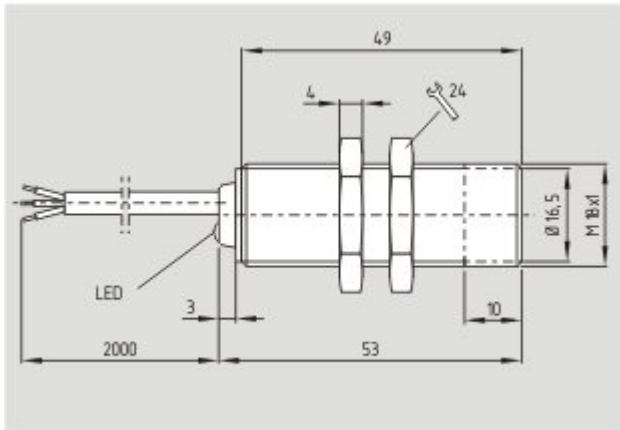

Dimensional drawing (basic component)

---

## System components

---

### Mounting accessories



#### 101068879 - MOUNTING CLAMP H 18

- For a smooth fitting of the proximity switches with cylindric shape  $\varnothing 18$  mm or thread M18

---

K.A. Schmersal GmbH & Co. KG, Möddinghofe 30, D-42279 Wuppertal

The data and values have been checked thoroughly. Technical modifications and errors excepted.

Generiert am 11.03.2016 - 15:34:31h Kasbase 0.0.0.F.64I