

1 Features

- Compact, easy to install, widely used in many industries
- DNF05-H Series is two stage filter with excellent insertion losses
- CE approved
- Customization accepted

2 Technical Parameters

Type	Rated Voltage	Rated Current	Hi-Pot Test Voltage		Cx(μF) ±10%	Cy(nF) ±20%	L(mH) -30%~+50%	R(MΩ) ±10%	Leakage Current 250V~50Hz
			Line-Line	Line-Ground					
DNF05-G-10A	250V-50/60Hz	10A	1800VDC,2s	1800V-50/60Hz,2s	0.1	3.3	3.0	0.68	<0.75mA
DNF05-20A	250V-50/60Hz	20A	1800VDC,2s	1800V-50/60Hz,2s	0.47	3.3	0.6	1.0	<0.75mA
DNF05-H-3A	250V-50/60Hz	3A	1800VDC,2s	1800V-50/60Hz,2s	0.15	4.7	1.4	0.68	<1.1mA
DNF05-H-5A	250V-50/60Hz	5A	1800VDC,2s	1800V-50/60Hz,2s	0.15	4.7	0.8	0.68	<1.1mA
DNF05-H-10A	250V-50/60Hz	10A	1800VDC,2s	1800V-50/60Hz,2s	0.15	4.7	0.6	0.68	<1.1mA
DNF05-H-15A	250V-50/60Hz	15A	1800VDC,2s	1800V-50/60Hz,2s	0.15	4.7	0.65	0.68	<1.1mA

3 Electrical Schematic

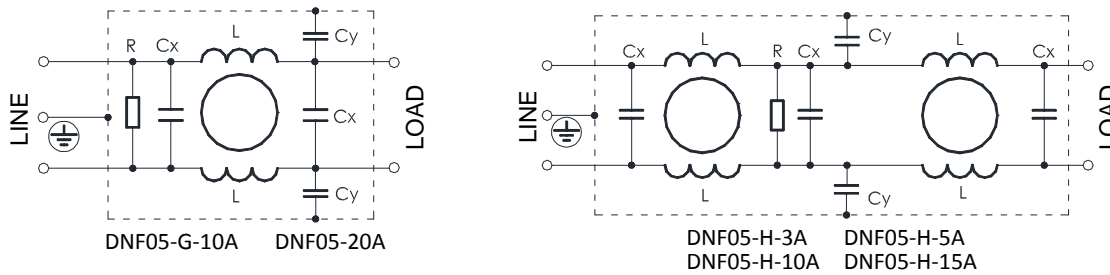

4 Dimensions (Unit: mm)

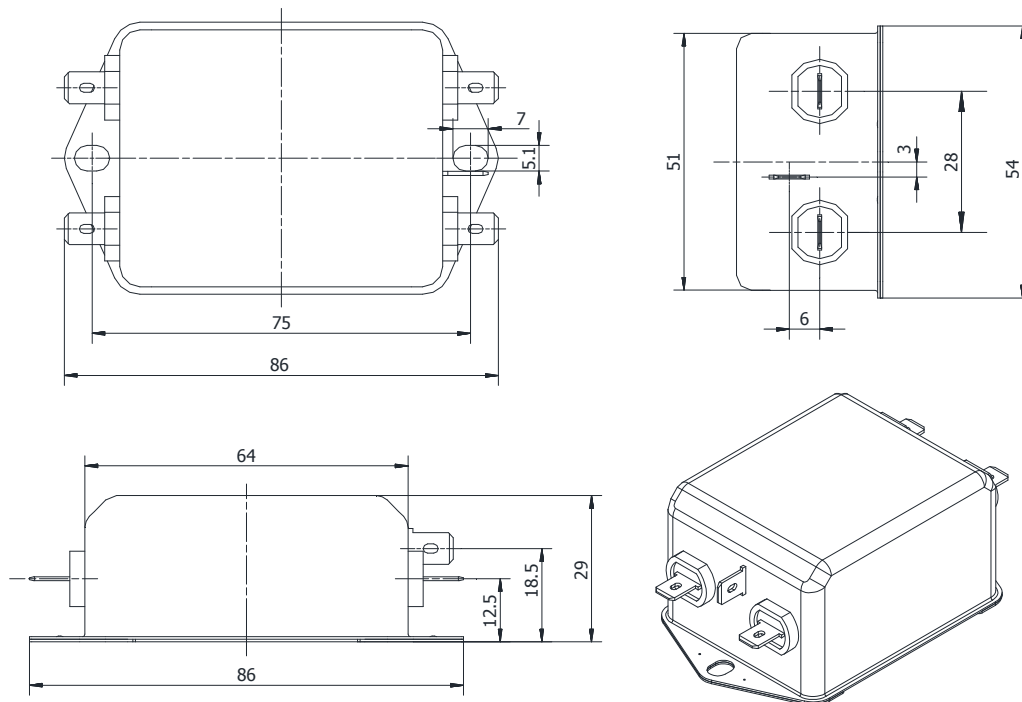

5 Typical Insertion Losses In 50Ω System: (CM-Common Mode DM-Different Mode)

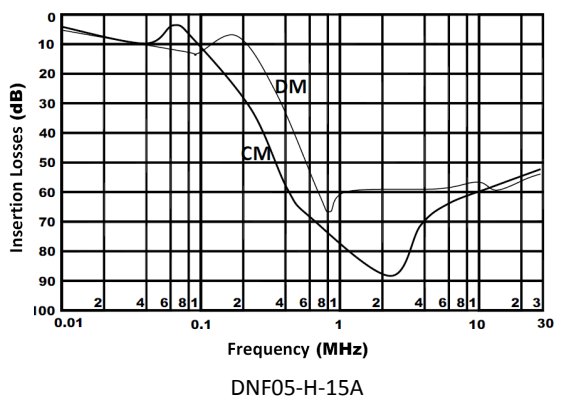
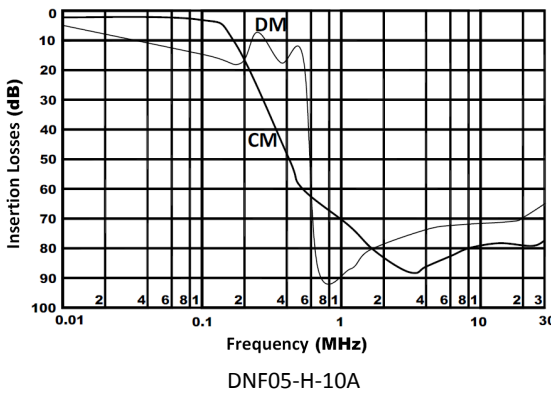
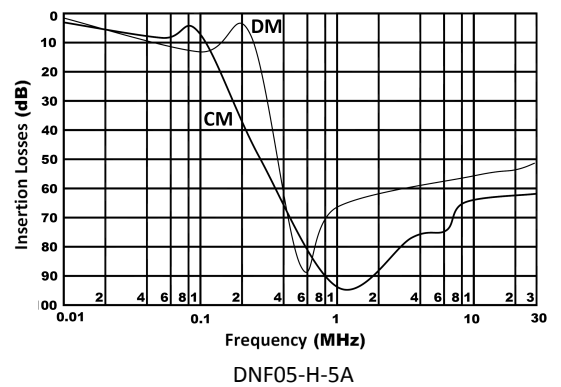
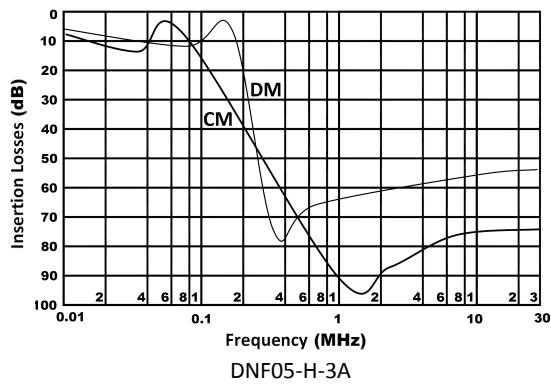
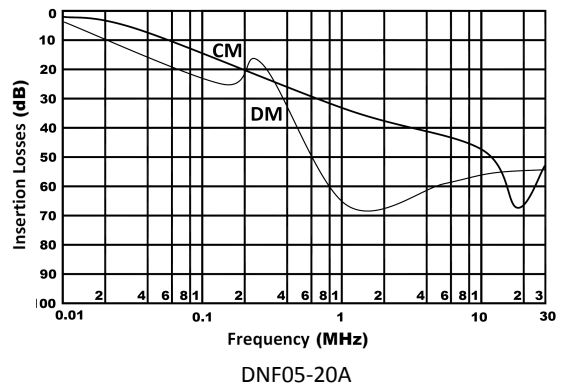
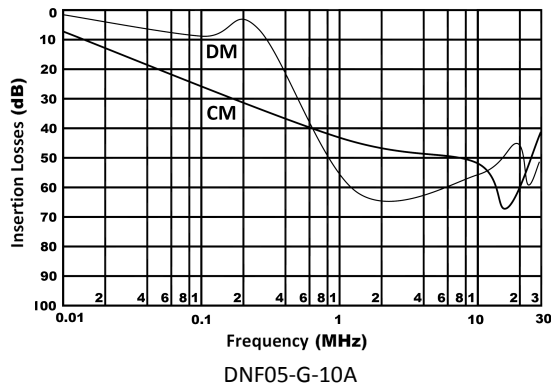

6 Installation Instructions

- 1 ) Good electrical connection is needed between filter casing and equipment shell.
- 2 ) Connecting the filter's input and output according to the provision on the label of LINE and LOAD.
- 3 ) The input wiring and the output wiring should be strictly separated, cannot be bundled together.