



FICHE D'INSTRUCTION TECHNIQUE

N°: V 54 1006

PINCE PNEUMATIQUE CLIC COMPACT
CLIC PNEUMATIC PLIERS
PINZA PNEUMATICA CLIC
PINZA NEUMATICA CLIC
CLIC DRUCKLUFTZANGE

Date : 10/01/2011

Indice : A

INSTRUCTIONS

CLIC PNEUMATIQUE PLIERS



Ets CAILLAU SAS
28, rue Ernest Renan
92130 ISSY-LES-MOULINEAUX
Té. 00 33 1 45 29 93 00
caillau@caillau.com

CAILLAU

COLLIERS DE SERRAGE ET CONNEXIONS

Translation of the original instructions



FICHE D'INSTRUCTION TECHNIQUE

N°: V 54 1006

PINCE PNEUMATIQUE CLIC COMPACT
CLIC PNEUMATIC PLIERS
PINZA PNEUMATICA CLIC
PINZA NEUMATICA CLIC
CLIC DRUCKLUFTZANGE

Date : 10/01/2011

Indice : A

1. TECHNICAL DESCRIPTION

1.1. Features

- 3-coaxial piston cylinder double acting
- Operating air pressure..... 5 to 6 bar
- Use dry, lubricated air.
- Air supply connection 1/8" BSP cylindrical thread
- Rotating head
- Cylinder operated by trigger
- Weight of the cylinder alone 0.600 Kg
- Weight of the cylinder with straight head 0.720 Kg
- Noise level..... <70 dBA

1.2. Dimensions

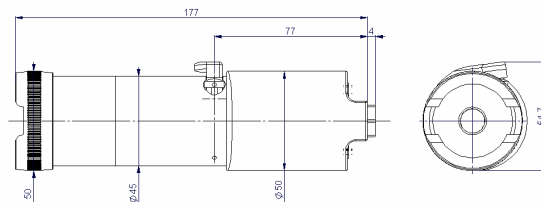

Short head

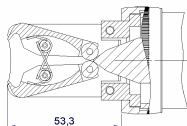

Half-long head

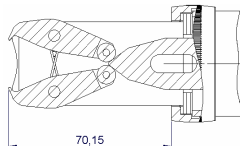

Long head

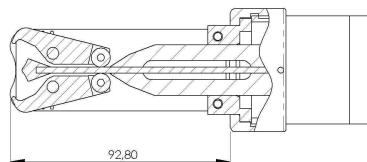

	FICHE D'INSTRUCTION TECHNIQUE	N°: V 54 1006
	PINCE PNEUMATIQUE CLIC COMPACT CLIC PNEUMATIC PLIERS PINZA PNEUMATICA CLIC PINZA NEUMATICA CLIC CLIC DRUCKLUFTZANGE	Date : 10/01/2011 Indice : A

1.3. Description

The CLIC pneumatic pliers consist of a cylinder on which an interchangeable (straight or slanted) head is fitted.

1.4. Operation

The two guide flanges ensure the lateral centring of the clamp.

The cylinder causes the jaws to move when you keep the trigger pressed.

1.5. Use

- 1.5.1. Line up the pliers perpendicular to the axis of the hose, with the two jaws in contact with the clamp's band.
- 1.5.2. Press the trigger and let the work be carried out without stress on the pliers.
- 1.5.3. Release the trigger.
- 1.5.4. Withdraw the pliers after complete opening of the jaws.

Simulation

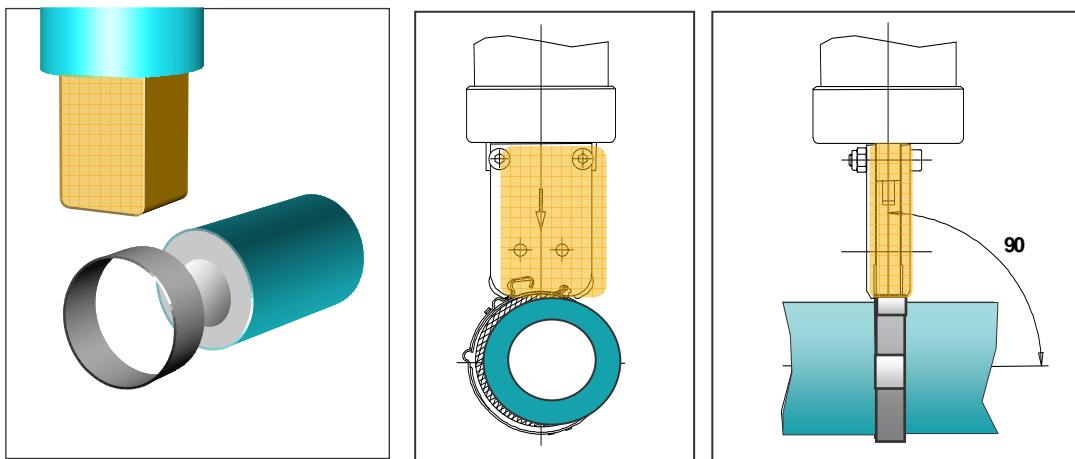

If fitting is automated, only the tool or the application may be fixed, not both.

	FICHE D'INSTRUCTION TECHNIQUE	N°: V 54 1006
	PINCE PNEUMATIQUE CLIC COMPACT CLIC PNEUMATIC PLIERS PINZA PNEUMATICA CLIC PINZA NEUMATICA CLIC CLIC DRUCKLUFTZANGE	Date : 10/01/2011 Indice : A

1.6. Parts list

Short straight pliers	CLIC	COMPLETE PLIERS	CYLINDER ALONE	HEAD ALONE	CLOSING DISTANCE	MAX. ALLOWABLE WEAR VALUE
	55	54 0 001 610	54 0 001 614	54 0 000 612	2,4	3
	66 – R 66 - 86	54 0 001 597	54 0 001 614	54 0 000 596	3	3,6
	76PréclipséR	54 0 001 635	54 0 001 614	54 0 000 634	2,4	3
	76 sp	54 0 001 723	54 0 001 620	54 0 000 732	2,4	3
	R 96	54 0 001 605	54 0 001 614	54 0 000 599	4,7	5,3
	GR-R86 - R96p07	54 0 001 640	54 0 001 614	54 0 000 642	7	7,6
	E – R 96 sp	54 0 001 720	54 0 001 620	54 0 000 731	7	7,6
	R 109	54 0 001 400	54 0 001 401	54 0 001 402	7	7,6

Extended straight pliers	CLIC	COMPLETE PLIERS	CYLINDER ALONE	HEAD ALONE	CLOSING DISTANCE	MAX. ALLOWABLE WEAR VALUE
	66 - R66-86	54 0 001 722	54 0 001 617	54 0 000 709	3	3,6
	GR-R86 - R96p07	54 0 001 633	54 0 001 617	54 0 000 632	7	7,6
	E - R96 sp	54 0 001 704	54 0 001 623	54 0 000 733	7	7,6

Half-long straight pliers	CLIC	COMPLETE PLIERS	CYLINDER ALONE	HEAD ALONE	CLOSING DISTANCE	MAX. ALLOWABLE WEAR VALUE
	R96 sans PO	54 0 001 717	54 0 001 613	54 0 000 605	7	7,6
	R86 – R96	54 0 001 719	54 0 001 613	54 0 000 606	7	7,6
	E – R 96 sp	54 0 001 739	54 0 000 619	54 0 000 735	7	7,6

Special straight pliers	CLIC	COMPLETE PLIERS	CYLINDER ALONE	HEAD ALONE	CLOSING DISTANCE	MAX. ALLOWABLE WEAR VALUE
	R86	54 0 001 607	54 0 001 614	54 0 000 598	7	7,6
	66–R66préclipsé	54 0 001 618	54 0 001 614	54 0 000 619	2.4	3

	FICHE D'INSTRUCTION TECHNIQUE	N°: V 54 1006
	PINCE PNEUMATIQUE CLIC COMPACT CLIC PNEUMATIC PLIERS PINZA PNEUMATICA CLIC PINZA NEUMATICA CLIC CLIC DRUCKLUFTZANGE	Date : 10/01/2011 Indice : A

Extended slanted pliers	CLIC	COMPLETE PLIERS	CYLINDER ALONE	HEAD ALONE	CLOSING DISTANCE	MAX. ALLOWABLE WEAR VALUE
	E - R96 sp		54 0 001 729	54 0 001 626	54 0 000 729	7

Offset pliers	CLIC	COMPLETE PLIERS	CYLINDER ALONE	HEAD ALONE	CLOSING DISTANCE	MAX. ALLOWABLE WEAR VALUE	
	R86		54 0 001 707	54 0 001 615	54 0 000 706	6.5	7,1
	R96 sp-E		54 0 001 708	54 0 001 625	54 0 000 708	6.5	7,1

Extended offset pliers	CLIC	COMPLETE PLIERS	CYLINDER ALONE	HEAD ALONE	CLOSING DISTANCE	MAX. ALLOWABLE WEAR VALUE	
	E - R96 sp		54 0 001 709	54 0 001 624	54 0 000 711	6,5	7,1
	R96 sp-E		54 0 001 708	54 0 001 625	54 0 000 708	6,5	7,1

Half-long offset pliers	CLIC	COMPLETE PLIERS	CYLINDER ALONE	HEAD ALONE	CLOSING DISTANCE	MAX. ALLOWABLE WEAR VALUE	
	R86-R96		54 0 101 752	54 0 001 637	54 0 100 758	6,5	7,1
	E - R96 sp-		54 0 001 752	54 0 001 637	54 0 000 758	6,5	7,1

	FICHE D'INSTRUCTION TECHNIQUE	N°: V 54 1006
	PINCE PNEUMATIQUE CLIC COMPACT CLIC PNEUMATIC PLIERS PINZA PNEUMATICA CLIC PINZA NEUMATICA CLIC CLIC DRUCKLUFTZANGE	Date : 10/01/2011 Indice : A

2. MAINTENANCE

2.1. Changing the valve

- 2.1.1. Disconnect the pliers from the compressed air system.
- 2.1.2. Unscrew the M4 X8 screw (1).
- 2.1.3. Remove the flange (2) and the trigger (3).
- 2.1.4. Unscrew the screw (4) and remove the push button (5).
- 2.1.5. Remove the circlips (6).
- 2.1.6. Remove parts (7)(8)(9) and (10).
- 2.1.7. Clean the hole.
- 2.1.8. Fit a valve repair kit.
- 2.1.9. Refit the circlips.
- 2.1.10. Refit the trigger (3) and the flange (2).
- 2.1.11. Tighten the screw (1).

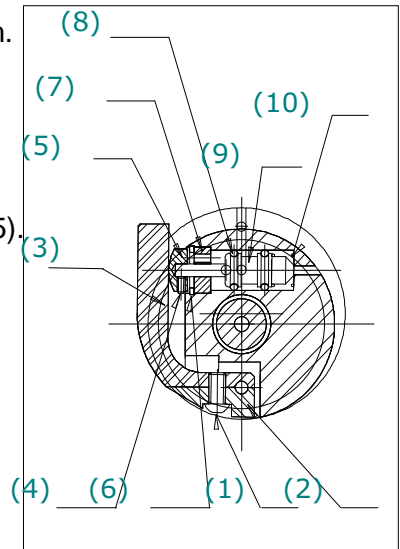

2.2. Spare parts for compact pliers

- Valve repair kit PN 54 0 001 632
- Push button/Key PN 54 0 001 629
- Pair of jaws (sold in sets of 5)..... PN see Table Column A
- Pair of axes for jaws PN see Table Column B
- Return spring for jaws PN see Table Column C



FICHE D'INSTRUCTION TECHNIQUE

N°: V 54 1006

**PINCE PNEUMATIQUE CLIC COMPACT
CLIC PNEUMATIC PLIERS
PINZA PNEUMATICA CLIC
PINZA NEUMATICA CLIC
CLIC DRUCKLUFTZANGE**

Date : 10/01/2011

Indice : A

Use on pliers:	A	B	C
	PN "Pair of jaws"	PN "Pair of axes for jaws"	PN "Return spring for jaws"
54 0 000 650	54 0 000 520	/	540 000 541
54 0 001 400	S 54 60 23 00 010	S 54 60 23 00 015	540 001 403
54 0 001 597	54 0 000 621	54 9 000 002	54 0 000 630
54 0 001 605	54 0 000 623	54 9 000 002	54 0 000 630
54 0 001 607	S 54 10 21 31 010	54 9 000 002	54 0 000 630
54 0 001 610	54 0 000 620	54 9 000 002	54 0 000 630
54 0 001 618	54 0 000 620	S 54 10 00	54 0 000 630
54 0 001 633	54 0 000 644	54 9 000 002	54 0 000 630
54 0 001 717	/	54 9 000 026	54 0 001 914
54 0 001 719	/	54 9 000 026	54 0 001 914
54 0 001 635	54 0 000 646	54 9 000 002	54 0 000 630
54 0 001 640	54 0 000 644	54 9 000 002	54 0 000 630
54 0 001 704	54 0 000 652	54 9 000 020	54 0 000 630
54 0 001 707	S 54 10 00 90 010	54 9 000 004	54 0 000 630
54 0 001 708	54 0 000 647	54 9 000 004	54 0 000 630
54 0 001 709	54 0 000 647	54 9 000 004	54 0 000 630
54 0 001 720	54 0 000 652	54 9 000 020	54 0 000 630
54 0 001 722	54 0 000 621	54 9 000 002	54 0 000 630
54 0 001 723	54 0 000 629	54 9 000 020	54 0 000 630
54 0 001 729	54 0 000 653	54 9 000 005	54 0 000 630
54 0 001 612	S 54 10 13 32 010	S 54 10 00 72 010	54 0 001 914
54 0 001 739	S 54 10 00 72 021	54 9 000 026	54 0 001 914
54 0 101 752	S 54 10 00 73 012	54 9 000 024	54 0 001 914
54 0 001 752	S 54 10 00 73 012	54 9 000 024	54 0 001 914

Tools must be maintained and serviced according to our specifications and instructions and using our spare parts.

Any modification, displacement of original dimensions or deviation beyond wear values can generate fitting defects.

For any operation other than the above, please refer to CAILLAU.

	FICHE D'INSTRUCTION TECHNIQUE	N°: V 54 1006
	PINCE PNEUMATIQUE CLIC COMPACT CLIC PNEUMATIC PLIERS PINZA PNEUMATICA CLIC PINZA NEUMATICA CLIC CLIC DRUCKLUFTZANGE	Date : 10/01/2011 Indice : A

	Problem	Causes	Solutions
1	The tool does not work.	Lack of compressed air.	Check connection and compressed air supply.
3	Compressed air leaks around the hose connection.	Coupling is loose.	Check hose connection.
6	Compressed air leaks around the control valve.	Control valve or gaskets are worn out.	Change the gaskets or the valve kit.
10	Loss of power	Improper air supply or leaks	Check that pressure complies with the recommendations of the instruction manual and search for leaks.

2.3. Safety instructions

Read this manual before using the tool and follow the operating and safety instructions in order to receive the maximum benefit of the fitting tool you just purchased.

CAILLAU assumes no liability for personal injury or property damage resulting from failure to comply with the safety instructions and rules contained in this manual.

To avoid any pinching risks, do not touch the pliers' working area.

Before performing any replacement or repair operation or when you are not using the tool, make sure you cut off the compressed air supply, bleed the hose and unplug the unit from the main supply.

Comply with the air pressure recommended in the manual.

Maintenance of the tool must be performed by trained personnel.

CAILLAU declines responsibility in case of:

- Modifications to the original structure of the fitting tool.
- Use of the fitting tool for any application other than that specified in the instruction manual.
- Replacements with components or parts unauthorized by CAILLAU.

All rights to this document are reserved.